

# Contract for the sale and purchase of land 2019 edition

<b>TERM</b>	<b>MEANING OF TERM</b>	<b>NSW DAN:</b>
vendor's agent	<b>Gittoes Real Estate</b> PO Box 4035, EAST GOSFORD NSW 2250	Phone: 4323 3811 Ref: Trent Mullen
co-agent		
vendor	<b>Catherine Anne Low</b> 4/27 Brougham Street, East Gosford, NSW 2250	
vendor's solicitor	<b>Central Coast Conveyancing Firm</b> Level 1 / 24 Dane Drive, GOSFORD NSW 2250	Phone: 02 4322 4444 Email: linda@cccfirm.com.au Fax: 02 4322 5555 Ref: LA:FW:17629
date for completion land (address, plan details and title reference)	<b>42nd day after the contract date</b> <b>4/27 Brougham Street, East Gosford, New South Wales 2250</b> <b>Registered Plan: Lot 4 Plan SP 30311</b> <b>Folio Identifier 4/SP30311</b>	(clause 15)
improvements	<input checked="" type="checkbox"/> VACANT POSSESSION <input type="checkbox"/> subject to existing tenancies <input type="checkbox"/> HOUSE <input checked="" type="checkbox"/> garage <input type="checkbox"/> carport <input checked="" type="checkbox"/> home unit <input type="checkbox"/> carspace <input type="checkbox"/> storage space <input type="checkbox"/> none <input type="checkbox"/> other:	
attached copies	<input type="checkbox"/> documents in the List of Documents as marked or as numbered: <input type="checkbox"/> other documents:	

**A real estate agent is permitted by legislation to fill up the items in this box in a sale of residential property.**

inclusions	<input checked="" type="checkbox"/> blinds <input type="checkbox"/> dishwasher <input checked="" type="checkbox"/> light fittings <input checked="" type="checkbox"/> stove <input checked="" type="checkbox"/> built-in wardrobes <input checked="" type="checkbox"/> fixed floor coverings <input checked="" type="checkbox"/> range hood <input type="checkbox"/> pool equipment <input type="checkbox"/> clothes line <input checked="" type="checkbox"/> insect screens <input type="checkbox"/> solar panels <input type="checkbox"/> TV antenna <input type="checkbox"/> curtains <input checked="" type="checkbox"/> other: ceiling fans, air-conditioner
exclusions	
purchaser	
purchaser's solicitor	
price	
deposit	_____ (10% of the price, unless otherwise stated)
balance	
contract date	(if not stated, the date this contract was made)

buyer's agent

	<b>GST AMOUNT (optional)</b> The price includes GST of: \$	<b>witness</b>
--	--	----------------

**purchaser**    JOINT TENANTS     tenants in common     in unequal shares    **witness**

**Choices**Vendor agrees to accept a **deposit-bond** (clause 3)  NO  yes**Nominated Electronic Lodgment Network (ELN)** (clause 30) PEXA**Electronic transaction** (clause 30)  no  YES(if no, vendor must provide further details, such as the proposed applicable waiver, in the space below, or serve *within* 14 days of the contract date):**Tax information (the parties promise this is correct as far as each party is aware)****Land tax** is adjustable  NO  yes**GST:** Taxable supply  NO  yes in full  yes to an extentMargin scheme will be used in making the taxable supply  NO  yes

This sale is not a taxable supply because (one or more of the following may apply) the sale is:

- not made in the course or furtherance of an enterprise that the vendor carries on (section 9-5(b))
- by a vendor who is neither registered nor required to be registered for GST (section 9-5(d))
- GST-free because the sale is the supply of a going concern under section 38-325
- GST-free because the sale is subdivided farm land or farm land supplied for farming under Subdivision 38-O
- input taxed because the sale is of eligible residential premises (sections 40-65, 40-75(2) and 195-1)

Purchaser must make an *GSTRW payment* (GST residential withholding payment)  NO  yes (if yes, vendor must provide further details)If the further details below are not fully completed at the contract date, the vendor must provide all these details in a separate notice *within* 14 days of the contract date.**GSTRW payment (GST residential withholding payment) – further details**

Frequently the supplier will be the vendor. However, sometimes further information will be required as to which entity is liable for GST, for example, if the supplier is a partnership, a trust, part of a GST group or a participant in a GST joint venture.

Supplier's name:

Supplier's ABN:

Supplier's GST branch number (if applicable):

Supplier's business address:

Supplier's email address:

Supplier's phone number:

Supplier's proportion of *GSTRW payment*:**If more than one supplier, provide the above details for each supplier.**Amount purchaser must pay – price multiplied by the *GSTRW rate* (residential withholding rate):Amount must be paid:  AT COMPLETION  at another time (specify):Is any of the consideration not expressed as an amount in money?  NO  yes

If "yes", the GST inclusive market value of the non-monetary consideration: \$

Other details (including those required by regulation or the ATO forms):

## List of Documents

General	Strata or community title (clause 23 of the contract)
<input checked="" type="checkbox"/> 1 property certificate for the land	<input checked="" type="checkbox"/> 32 property certificate for strata common property
<input checked="" type="checkbox"/> 2 plan of the land	<input checked="" type="checkbox"/> 33 plan creating strata common property
<input type="checkbox"/> 3 unregistered plan of the land	<input checked="" type="checkbox"/> 34 strata by-laws
<input type="checkbox"/> 4 plan of land to be subdivided	<input type="checkbox"/> 35 strata development contract or statement
<input type="checkbox"/> 5 document that is to be lodged with a relevant plan	<input type="checkbox"/> 36 strata management statement
<input checked="" type="checkbox"/> 6 section 10.7(2) planning certificate under Environmental Planning and Assessment Act 1979	<input type="checkbox"/> 37 strata renewal proposal
<input type="checkbox"/> 7 additional information included in that certificate under section 10.7(5)	<input type="checkbox"/> 38 strata renewal plan
<input checked="" type="checkbox"/> 8 sewerage infrastructure location diagram (service location diagram)	<input type="checkbox"/> 39 leasehold strata - lease of lot and common property
<input checked="" type="checkbox"/> 9 sewer lines location diagram (sewerage service diagram)	<input type="checkbox"/> 40 property certificate for neighbourhood property
<input type="checkbox"/> 10 document that created or may have created an easement, profit à prendre, restriction on use or positive covenant disclosed in this contract	<input type="checkbox"/> 41 plan creating neighbourhood property
<input type="checkbox"/> 11 <i>planning agreement</i>	<input type="checkbox"/> 42 neighbourhood development contract
<input type="checkbox"/> 12 section 88G certificate (positive covenant)	<input type="checkbox"/> 43 neighbourhood management statement
<input type="checkbox"/> 13 survey report	<input type="checkbox"/> 44 property certificate for precinct property
<input type="checkbox"/> 14 building information certificate or building certificate given under <i>legislation</i>	<input type="checkbox"/> 45 plan creating precinct property
<input type="checkbox"/> 15 lease (with every relevant memorandum or variation)	<input type="checkbox"/> 46 precinct development contract
<input type="checkbox"/> 16 other document relevant to tenancies	<input type="checkbox"/> 47 precinct management statement
<input type="checkbox"/> 17 licence benefiting the land	<input type="checkbox"/> 48 property certificate for community property
<input type="checkbox"/> 18 old system document	<input type="checkbox"/> 49 plan creating community property
<input type="checkbox"/> 19 Crown purchase statement of account	<input type="checkbox"/> 50 community development contract
<input type="checkbox"/> 20 building management statement	<input type="checkbox"/> 51 community management statement
<input checked="" type="checkbox"/> 21 form of requisitions	<input type="checkbox"/> 52 document disclosing a change of by-laws
<input type="checkbox"/> 22 <i>clearance certificate</i>	<input type="checkbox"/> 53 document disclosing a change in a development or management contract or statement
<input type="checkbox"/> 23 land tax certificate	<input type="checkbox"/> 54 document disclosing a change in boundaries
<b>Home Building Act 1989</b>	<input type="checkbox"/> 55 information certificate under Strata Schemes Management Act 2015
<input type="checkbox"/> 24 insurance certificate	<input type="checkbox"/> 56 information certificate under Community Land Management Act 1989
<input type="checkbox"/> 25 brochure or warning	<input type="checkbox"/> 57 disclosure statement - off the plan contract
<input type="checkbox"/> 26 evidence of alternative indemnity cover	<input type="checkbox"/> 58 other document relevant to the off the plan contract
<b>Swimming Pools Act 1992</b>	<b>Other</b>
<input type="checkbox"/> 27 certificate of compliance	<input type="checkbox"/> 59
<input type="checkbox"/> 28 evidence of registration	
<input type="checkbox"/> 29 relevant occupation certificate	
<input type="checkbox"/> 30 certificate of non-compliance	
<input type="checkbox"/> 31 detailed reasons of non-compliance	

**HOLDER OF STRATA OR COMMUNITY TITLE RECORDS – Name, address, email address and telephone number**

BCS Strata Management  
 PO Box 930, GOSFORD NSW 2250 Phone: 4331 5300  
 bcs\_centralcoast@bcssm.com.au

**IMPORTANT NOTICE TO VENDORS AND PURCHASERS**

Before signing this contract you should ensure that you understand your rights and obligations, some of which are not written in this contract but are implied by law.

**WARNING—SMOKE ALARMS**

The owners of certain types of buildings and strata lots must have smoke alarms (or in certain cases heat alarms) installed in the building or lot in accordance with regulations under the *Environmental Planning and Assessment Act 1979*. It is an offence not to comply. It is also an offence to remove or interfere with a smoke alarm or heat alarm. Penalties apply.

**WARNING—LOOSE-FILL ASBESTOS INSULATION**

Before purchasing land that includes any residential premises (within the meaning of Division 1A of Part 8 of the *Home Building Act 1989*) built before 1985, a purchaser is strongly advised to consider the possibility that the premises may contain loose-fill asbestos insulation (within the meaning of Division 1A of Part 8 of the *Home Building Act 1989*). In particular, a purchaser should:

- (a) search the Register required to be maintained under Division 1A of Part 8 of the *Home Building Act 1989*, and
- (b) ask the relevant local council whether it holds any records showing that the residential premises contain loose-fill asbestos insulation.

For further information about loose-fill asbestos insulation (including areas in which residential premises have been identified as containing loose-fill asbestos insulation), contact NSW Fair Trading.

### **COOLING OFF PERIOD (PURCHASER'S RIGHTS)**

1. This is the statement required by section 66X of the *Conveyancing Act 1919* and applies to a contract for the sale of residential property.
2. EXCEPT in the circumstances listed in paragraph 3, the purchaser may rescind the contract at any time before 5 pm on—
  - (a) the tenth business day after the day on which the contract was made—in the case of an off the plan contract, or
  - (b) the fifth business day after the day on which the contract was made—in any other case.
3. There is NO COOLING OFF PERIOD:
  - (a) if, at or before the time the contract is made, the purchaser gives to the vendor (or the vendor's solicitor or agent) a certificate that complies with section 66W of the Act, or
  - (b) if the property is sold by public auction, or
  - (c) if the contract is made on the same day as the property was offered for sale by public auction but passed in, or
  - (d) if the contract is made in consequence of the exercise of an option to purchase the property, other than an option that is void under section 66ZG of the Act.
4. A purchaser exercising the right to cool off by rescinding the contract will forfeit to the vendor 0.25% of the purchase price of the property. The vendor is entitled to recover the amount forfeited from any amount paid by the purchaser as a deposit under the contract and the purchaser is entitled to a refund of any balance.

### **DISPUTES**

If you get into a dispute with the other party, the Law Society and Real Estate Institute encourage you to use informal procedures such as negotiation, independent expert appraisal, the Law Society Conveyancing Dispute Resolution Scheme or mediation (for example mediation under the Law Society Mediation Program).

### **AUCTIONS**

Regulations made under the Property, Stock and Business Agents Act 2002 prescribe a number of conditions applying to sales by auction.

### WARNINGS

1. Various Acts of Parliament and other matters can affect the rights of the parties to this contract. Some important matters are actions, claims, decisions, licences, notices, orders, proposals or rights of way involving:
 

<b>APA Group</b> <b>Australian Taxation Office</b> <b>Council</b> <b>County Council</b> <b>Department of Planning, Industry and Environment</b> <b>Department of Primary Industries</b> <b>Electricity and gas</b> <b>Land &amp; Housing Corporation</b> <b>Local Land Services</b>	<b>NSW Department of Education</b> <b>NSW Fair Trading</b> <b>Owner of adjoining land</b> <b>Privacy</b> <b>Public Works Advisory</b> <b>Subsidence Advisory NSW</b> <b>Telecommunications</b> <b>Transport for NSW</b> <b>Water, sewerage or drainage authority</b>
---	--

If you think that any of these matters affects the property, tell your solicitor.
2. A lease may be affected by the Agricultural Tenancies Act 1990, the Residential Tenancies Act 2010 or the Retail Leases Act 1994.
3. If any purchase money is owing to the Crown, it will become payable before obtaining consent, or if no consent is needed, when the transfer is registered.
4. If a consent to transfer is required under legislation, see clause 27 as to the obligations of the parties.
5. The vendor should continue the vendor's insurance until completion. If the vendor wants to give the purchaser possession before completion, the vendor should first ask the insurer to confirm this will not affect the insurance.
6. The purchaser will usually have to pay transfer duty (and sometimes surcharge purchaser duty) on this contract. If duty is not paid on time, a purchaser may incur penalties.
7. If the purchaser agrees to the release of deposit, the purchaser's right to recover the deposit may stand behind the rights of others (for example the vendor's mortgagee).
8. The purchaser should arrange insurance as appropriate.
9. Some transactions involving personal property may be affected by the Personal Property Securities Act 2009.
10. A purchaser should be satisfied that finance will be available at the time of completing the purchase.
11. Where the market value of the property is at or above a legislated amount, the purchaser may have to comply with a foreign resident capital gains withholding payment obligation (even if the vendor is not a foreign resident). If so, this will affect the amount available to the vendor on completion.
12. Purchasers of some residential properties may have to withhold part of the purchase price to be credited towards the GST liability of the vendor. If so, this will also affect the amount available to the vendor. More information is available from the ATO.

The vendor sells and the purchaser buys the *property* for the price under these provisions instead of Schedule 3 Conveyancing Act 1919, subject to any *legislation* that cannot be excluded.

## 1 Definitions (a term in italics is a defined term)

In this contract, these terms (in any form) mean –

<i>adjustment date</i>	the earlier of the giving of possession to the purchaser or completion;
<i>bank</i>	the Reserve Bank of Australia or an authorised deposit-taking institution which is a bank, a building society or a credit union;
<i>business day</i>	any day except a bank or public holiday throughout NSW or a Saturday or Sunday;
<i>cheque</i>	a cheque that is not postdated or stale;
<i>clearance certificate</i>	a certificate within the meaning of s14-220 of Schedule 1 to the <i>TA Act</i> , that covers one or more days falling within the period from and including the contract date to completion;
<i>deposit-bond</i>	a deposit bond or guarantee from an issuer, with an expiry date and for an amount each approved by the vendor;
<i>depositholder</i>	vendor's agent (or if no vendor's agent is named in this contract, the vendor's <i>solicitor</i> , or if no vendor's <i>solicitor</i> is named in this contract, the buyer's agent);
<i>document of title</i>	document relevant to the title or the passing of title;
<i>FRCGW percentage</i>	the percentage mentioned in s14-200(3)(a) of Schedule 1 to the <i>TA Act</i> (12.5% as at 1 July 2017);
<i>FRCGW remittance</i>	a remittance which the purchaser must make under s14-200 of Schedule 1 to the <i>TA Act</i> , being the lesser of the <i>FRCGW percentage</i> of the price (inclusive of GST, if any) and the amount specified in a <i>variation served by a party</i> ;
<i>GST Act</i>	A New Tax System (Goods and Services Tax) Act 1999;
<i>GST rate</i>	the rate mentioned in s4 of A New Tax System (Goods and Services Tax Imposition - General) Act 1999 (10% as at 1 July 2000);
<i>GSTRW payment</i>	a payment which the purchaser must make under s14-250 of Schedule 1 to the <i>TA Act</i> (the price multiplied by the <i>GSTRW rate</i> );
<i>GSTRW rate</i>	the rate determined under ss14-250(6), (8) or (9) of Schedule 1 to the <i>TA Act</i> (as at 1 July 2018, usually 7% of the price if the margin scheme applies, 1/11 <sup>th</sup> if not);
<i>legislation</i>	an Act or a by-law, ordinance, regulation or rule made under an Act;
<i>normally</i>	subject to any other provision of this contract;
<i>party</i>	each of the vendor and the purchaser;
<i>property</i>	the land, the improvements, all fixtures and the inclusions, but not the exclusions;
<i>planning agreement</i>	a valid voluntary agreement within the meaning of s7.4 of the Environmental Planning and Assessment Act 1979 entered into in relation to the <i>property</i> ;
<i>requisition</i>	an objection, question or requisition (but the term does not include a claim);
<i>rescind</i>	rescind this contract from the beginning;
<i>serve</i>	serve in writing on the other <i>party</i> ;
<i>settlement cheque</i>	an unendorsed <i>cheque</i> made payable to the person to be paid and – <ul style="list-style-type: none"> <li>• issued by a <i>bank</i> and drawn on itself; or</li> <li>• if authorised in writing by the vendor or the vendor's <i>solicitor</i>, some other <i>cheque</i>;</li> </ul>
<i>solicitor</i>	in relation to a <i>party</i> , the <i>party's</i> solicitor or licensed conveyancer named in this contract or in a notice <i>served by the party</i> ;
<i>TA Act</i>	Taxation Administration Act 1953;
<i>terminate</i>	terminate this contract for breach;
<i>variation</i>	a variation made under s14-235 of Schedule 1 to the <i>TA Act</i> ;
<i>within</i>	in relation to a period, at any time before or during the period; and
<i>work order</i>	a valid direction, notice or order that requires work to be done or money to be spent on or in relation to the <i>property</i> or any adjoining footpath or road (but the term does not include a notice under s22E of the Swimming Pools Act 1992 or clause 22 of the Swimming Pools Regulation 2018).

## 2 Deposit and other payments before completion

- 2.1 The purchaser must pay the deposit to the *depositholder* as stakeholder.
- 2.2 *Normally*, the purchaser must pay the deposit on the making of this contract, and this time is essential.
- 2.3 If this contract requires the purchaser to pay any of the deposit by a later time, that time is also essential.
- 2.4 The purchaser can pay any of the deposit by giving cash (up to \$2,000) or by unconditionally giving a *cheque* to the *depositholder* or to the vendor, vendor's agent or vendor's *solicitor* for sending to the *depositholder* or by payment by electronic funds transfer to the *depositholder*.
- 2.5 If any of the deposit is not paid on time or a *cheque* for any of the deposit is not honoured on presentation, the vendor can *terminate*. This right to *terminate* is lost as soon as the deposit is paid in full.
- 2.6 If the vendor accepts a bond or guarantee for the deposit, clauses 2.1 to 2.5 do not apply.

- 2.7 If the vendor accepts a bond or guarantee for part of the deposit, clauses 2.1 to 2.5 apply only to the balance.
- 2.8 If any of the deposit or of the balance of the price is paid before completion to the vendor or as the vendor directs, it is a charge on the land in favour of the purchaser until *termination* by the vendor or completion, subject to any existing right.
- 2.9 If each *party* tells the *depositholder* that the deposit is to be invested, the *depositholder* is to invest the deposit (at the risk of the *party* who becomes entitled to it) with a *bank*, in an interest-bearing account in NSW, payable at call, with interest to be reinvested, and pay the interest to the *parties* equally, after deduction of all proper government taxes and financial institution charges and other charges.

### 3 Deposit-bond

- 3.1 This clause applies only if this contract says the vendor has agreed to accept a *deposit-bond* for the deposit (or part of it).
- 3.2 The purchaser must provide the original *deposit-bond* to the vendor's *solicitor* (or if no *solicitor* the *depositholder*) at or before the making of this contract and this time is essential.
- 3.3 If the *deposit-bond* has an expiry date and completion does not occur by the date which is 14 days before the expiry date, the purchaser must *serve* a replacement *deposit-bond* at least 7 days before the expiry date. The time for service is essential.
- 3.4 The vendor must approve a replacement *deposit-bond* if –
- 3.4.1 it is from the same issuer and for the same amount as the earlier *deposit-bond*; and
- 3.4.2 it has an expiry date at least three months after its date of issue.
- 3.5 A breach of clauses 3.2 or 3.3 entitles the vendor to *terminate*. The right to *terminate* is lost as soon as –
- 3.5.1 the purchaser *serves* a replacement *deposit-bond*; or
- 3.5.2 the deposit is paid in full under clause 2.
- 3.6 Clauses 3.3 and 3.4 can operate more than once.
- 3.7 If the purchaser *serves* a replacement *deposit-bond*, the vendor must *serve* the earlier *deposit-bond*.
- 3.8 The amount of any *deposit-bond* does not form part of the price for the purposes of clause 16.7.
- 3.9 The vendor must give the purchaser the *deposit-bond* –
- 3.9.1 on completion; or
- 3.9.2 if this contract is *rescinded*.
- 3.10 If this contract is *terminated* by the vendor –
- 3.10.1 *normally*, the vendor can immediately demand payment from the issuer of the *deposit-bond*; or
- 3.10.2 if the purchaser *serves* prior to *termination* a notice disputing the vendor's right to *terminate*, the vendor must forward the *deposit-bond* (or its proceeds if called up) to the *depositholder* as stakeholder.
- 3.11 If this contract is *terminated* by the purchaser –
- 3.11.1 *normally*, the vendor must give the purchaser the *deposit-bond*; or
- 3.11.2 if the vendor *serves* prior to *termination* a notice disputing the purchaser's right to *terminate*, the vendor must forward the *deposit-bond* (or its proceeds if called up) to the *depositholder* as stakeholder.

### 4 Transfer

- 4.1 *Normally*, the purchaser must *serve* at least 14 days before the date for completion –
- 4.1.1 the form of transfer; and
- 4.1.2 particulars required to register any mortgage or other dealing to be lodged with the transfer by the purchaser or the purchaser's mortgagee.
- 4.2 If any information needed for the form of transfer is not disclosed in this contract, the vendor must *serve* it.
- 4.3 If the purchaser *serves* a form of transfer and the transferee is not the purchaser, the purchaser must give the vendor a direction signed by the purchaser personally for this form of transfer.
- 4.4 The vendor can require the purchaser to include a form of covenant or easement in the transfer only if this contract contains the wording of the proposed covenant or easement, and a description of the land benefited.

### 5 Requisitions

- 5.1 If a form of *requisitions* is attached to this contract, the purchaser is taken to have made those *requisitions*.
- 5.2 If the purchaser is or becomes entitled to make any other *requisition*, the purchaser can make it only by *servicing* it –
- 5.2.1 if it arises out of this contract or it is a general question about the *property* or title - *within* 21 days after the contract date;
- 5.2.2 if it arises out of anything *served* by the vendor - *within* 21 days after the later of the contract date and that *service*; and
- 5.2.3 in any other case - *within* a reasonable time.

### 6 Error or misdescription

- 6.1 *Normally*, the purchaser can (but only before completion) claim compensation for an error or misdescription in this contract (as to the *property*, the title or anything else and whether substantial or not).
- 6.2 This clause applies even if the purchaser did not take notice of or rely on anything in this contract containing or giving rise to the error or misdescription.
- 6.3 However, this clause does not apply to the extent the purchaser knows the true position.



**7 Claims by purchaser**

*Normally*, the purchaser can make a claim (including a claim under clause 6) before completion only by *servicing* it with a statement of the amount claimed, and if the purchaser makes one or more claims before completion –

- 7.1 the vendor can *rescind* if in the case of claims that are not claims for delay –
- 7.1.1 the total amount claimed exceeds 5% of the price;
  - 7.1.2 the vendor *serves* notice of intention to *rescind*; and
  - 7.1.3 the purchaser does not *serve* notice waiving the claims *within* 14 days after that *service*; and
- 7.2 if the vendor does not *rescind*, the *parties* must complete and if this contract is completed –
- 7.2.1 the lesser of the total amount claimed and 10% of the price must be paid out of the price to and held by the *depositholder* until the claims are finalised or lapse;
  - 7.2.2 the amount held is to be invested in accordance with clause 2.9;
  - 7.2.3 the claims must be finalised by an arbitrator appointed by the *parties* or, if an appointment is not made *within* 1 month of completion, by an arbitrator appointed by the President of the Law Society at the request of a *party* (in the latter case the *parties* are bound by the terms of the Conveyancing Arbitration Rules approved by the Law Society as at the date of the appointment);
  - 7.2.4 the purchaser is not entitled, in respect of the claims, to more than the total amount claimed and the costs of the purchaser;
  - 7.2.5 net interest on the amount held must be paid to the *parties* in the same proportion as the amount held is paid; and
  - 7.2.6 if the *parties* do not appoint an arbitrator and neither *party* requests the President to appoint an arbitrator *within* 3 months after completion, the claims lapse and the amount belongs to the vendor.

**8 Vendor's rights and obligations**

- 8.1 The vendor can *rescind* if –
- 8.1.1 the vendor is, on reasonable grounds, unable or unwilling to comply with a *requisition*;
  - 8.1.2 the vendor *serves* a notice of intention to *rescind* that specifies the *requisition* and those grounds; and
  - 8.1.3 the purchaser does not *serve* a notice waiving the *requisition within* 14 days after that *service*.
- 8.2 If the vendor does not comply with this contract (or a notice under or relating to it) in an essential respect, the purchaser can *terminate* by *servicing* a notice. After the *termination* –
- 8.2.1 the purchaser can recover the deposit and any other money paid by the purchaser under this contract;
  - 8.2.2 the purchaser can sue the vendor to recover damages for breach of contract; and
  - 8.2.3 if the purchaser has been in possession a *party* can claim for a reasonable adjustment.

**9 Purchaser's default**

If the purchaser does not comply with this contract (or a notice under or relating to it) in an essential respect, the vendor can *terminate* by *servicing* a notice. After the *termination* the vendor can –

- 9.1 keep or recover the deposit (to a maximum of 10% of the price);
- 9.2 hold any other money paid by the purchaser under this contract as security for anything recoverable under this clause –
- 9.2.1 for 12 months after the *termination*; or
  - 9.2.2 if the vendor commences proceedings under this clause *within* 12 months, until those proceedings are concluded; and
- 9.3 sue the purchaser either –
- 9.3.1 where the vendor has resold the *property* under a contract made *within* 12 months after the *termination*, to recover –
    - the deficiency on resale (with credit for any of the deposit kept or recovered and after allowance for any capital gains tax or goods and services tax payable on anything recovered under this clause); and
    - the reasonable costs and expenses arising out of the purchaser's non-compliance with this contract or the notice and of resale and any attempted resale; or
  - 9.3.2 to recover damages for breach of contract.

**10 Restrictions on rights of purchaser**

- 10.1 The purchaser cannot make a claim or *requisition* or *rescind* or *terminate* in respect of –
- 10.1.1 the ownership or location of any fence as defined in the Dividing Fences Act 1991;
  - 10.1.2 a service for the *property* being a joint service or passing through another property, or any service for another property passing through the *property* ('service' includes air, communication, drainage, electricity, garbage, gas, oil, radio, sewerage, telephone, television or water service);
  - 10.1.3 a wall being or not being a party wall in any sense of that term or the *property* being affected by an easement for support or not having the benefit of an easement for support;
  - 10.1.4 any change in the *property* due to fair wear and tear before completion;
  - 10.1.5 a promise, representation or statement about this contract, the *property* or the title, not set out or referred to in this contract;
  - 10.1.6 a condition, exception, reservation or restriction in a Crown grant;

- 10.1.7 the existence of any authority or licence to explore or prospect for gas, minerals or petroleum;
- 10.1.8 any easement or restriction on use the substance of either of which is disclosed in this contract or any non-compliance with the easement or restriction on use; or
- 10.1.9 anything the substance of which is disclosed in this contract (except a caveat, charge, mortgage, priority notice or writ).
- 10.2 The purchaser cannot *rescind* or *terminate* only because of a defect in title to or quality of the inclusions.
- 10.3 *Normally*, the purchaser cannot make a claim or *requisition* or *rescind* or *terminate* or require the vendor to change the nature of the title disclosed in this contract (for example, to remove a caution evidencing qualified title, or to lodge a plan of survey as regards limited title).
- 11 Compliance with work orders**
- 11.1 *Normally*, the vendor must by completion comply with a *work order* made on or before the contract date and if this contract is completed the purchaser must comply with any other *work order*.
- 11.2 If the purchaser complies with a *work order*, and this contract is *rescinded* or *terminated*, the vendor must pay the expense of compliance to the purchaser.
- 12 Certificates and inspections**
- The vendor must do everything reasonable to enable the purchaser, subject to the rights of any tenant –
- 12.1 to have the *property* inspected to obtain any certificate or report reasonably required;
- 12.2 to apply (if necessary in the name of the vendor) for –
- 12.2.1 any certificate that can be given in respect of the *property* under *legislation*; or
- 12.2.2 a copy of any approval, certificate, consent, direction, notice or order in respect of the *property* given under *legislation*, even if given after the contract date; and
- 12.3 to make 1 inspection of the *property* in the 3 days before a time appointed for completion.
- 13 Goods and services tax (GST)**
- 13.1 Terms used in this clause which are not defined elsewhere in this contract and have a defined meaning in the *GST Act* have the same meaning in this clause.
- 13.2 *Normally*, if a *party* must pay the price or any other amount to the other *party* under this contract, GST is not to be added to the price or amount.
- 13.3 If under this contract a *party* must make an adjustment or payment for an expense of another party or pay an expense payable by or to a third party (for example, under clauses 14 or 20.7) –
- 13.3.1 the *party* must adjust or pay on completion any GST added to or included in the expense; but
- 13.3.2 the amount of the expense must be reduced to the extent the party receiving the adjustment or payment (or the representative member of a GST group of which that party is a member) is entitled to an input tax credit for the expense; and
- 13.3.3 if the adjustment or payment under this contract is consideration for a taxable supply, an amount for GST must be added at the *GST rate*.
- 13.4 If this contract says this sale is the supply of a going concern –
- 13.4.1 the *parties* agree the supply of the *property* is a supply of a going concern;
- 13.4.2 the vendor must, between the contract date and completion, carry on the enterprise conducted on the land in a proper and business-like way;
- 13.4.3 if the purchaser is not registered by the date for completion, the *parties* must complete and the purchaser must pay on completion, in addition to the price, an amount being the price multiplied by the *GST rate* ("the retention sum"). The retention sum is to be held by the *depositholder* and dealt with as follows –
- if *within* 3 months of completion the purchaser *serves* a letter from the Australian Taxation Office stating the purchaser is registered with a date of effect of registration on or before completion, the *depositholder* is to pay the retention sum to the purchaser; but
  - if the purchaser does not *serve* that letter *within* 3 months of completion, the *depositholder* is to pay the retention sum to the vendor; and
- 13.4.4 if the vendor, despite clause 13.4.1, *serves* a letter from the Australian Taxation Office stating the vendor has to pay GST on the supply, the purchaser must pay to the vendor on demand the amount of GST assessed.
- 13.5 *Normally*, the vendor promises the margin scheme will not apply to the supply of the *property*.
- 13.6 If this contract says the margin scheme is to apply in making the taxable supply, the *parties* agree that the margin scheme is to apply to the sale of the *property*.
- 13.7 If this contract says the sale is not a taxable supply –
- 13.7.1 the purchaser promises that the *property* will not be used and represents that the purchaser does not intend the *property* (or any part of the *property*) to be used in a way that could make the sale a taxable supply to any extent; and
- 13.7.2 the purchaser must pay the vendor on completion in addition to the price an amount calculated by multiplying the price by the *GST rate* if this sale is a taxable supply to any extent because of –
- a breach of clause 13.7.1; or
  - something else known to the purchaser but not the vendor.
- 13.8 If this contract says this sale is a taxable supply in full and does not say the margin scheme applies to the *property*, the vendor must pay the purchaser on completion an amount of one-eleventh of the price if –

- 13.8.1 this sale is not a taxable supply in full; or
- 13.8.2 the margin scheme applies to the *property* (or any part of the *property*).
- 13.9 If this contract says this sale is a taxable supply to an extent –
- 13.9.1 clause 13.7.1 does not apply to any part of the *property* which is identified as being a taxable supply; and
- 13.9.2 the payments mentioned in clauses 13.7 and 13.8 are to be recalculated by multiplying the relevant payment by the proportion of the price which represents the value of that part of the *property* to which the clause applies (the proportion to be expressed as a number between 0 and 1). Any evidence of value must be obtained at the expense of the vendor.
- 13.10 *Normally*, on completion the vendor must give the recipient of the supply a tax invoice for any taxable supply by the vendor by or under this contract.
- 13.11 The vendor does not have to give the purchaser a tax invoice if the margin scheme applies to a taxable supply.
- 13.12 If the vendor is liable for GST on rents or profits due to issuing an invoice or receiving consideration before completion, any adjustment of those amounts must exclude an amount equal to the vendor's GST liability.
- 13.13 If the purchaser must make a *GSTRW payment* the purchaser must –
- 13.13.1 at least 5 days before the date for completion, *serve* evidence of submission of a *GSTRW payment* notification form to the Australian Taxation Office by the purchaser or, if a direction under clause 4.3 has been *served*, by the transferee named in the transfer *served* with that direction;
- 13.13.2 produce on completion a *settlement cheque* for the *GSTRW payment* payable to the Deputy Commissioner of Taxation;
- 13.13.3 forward the *settlement cheque* to the payee immediately after completion; and
- 13.13.4 *serve* evidence of receipt of payment of the *GSTRW payment* and a copy of the settlement date confirmation form submitted to the Australian Taxation Office.

#### 14 Adjustments

- 14.1 *Normally*, the vendor is entitled to the rents and profits and will be liable for all rates, water, sewerage and drainage service and usage charges, land tax, levies and all other periodic outgoings up to and including the *adjustment date* after which the purchaser will be entitled and liable.
- 14.2 The *parties* must make any necessary adjustment on completion.
- 14.3 If an amount that is adjustable under this contract has been reduced under *legislation*, the *parties* must on completion adjust the reduced amount.
- 14.4 The *parties* must not adjust surcharge land tax (as defined in the Land Tax Act 1956) but must adjust any other land tax for the year current at the *adjustment date* –
- 14.4.1 only if land tax has been paid or is payable for the year (whether by the vendor or by a predecessor in title) and this contract says that land tax is adjustable;
- 14.4.2 by adjusting the amount that would have been payable if at the start of the year –
- the person who owned the land owned no other land;
  - the land was not subject to a special trust or owned by a non-concessional company; and
  - if the land (or part of it) had no separate taxable value, by calculating its separate taxable value on a proportional area basis.
- 14.5 If any other amount that is adjustable under this contract relates partly to the land and partly to other land, the *parties* must adjust it on a proportional area basis.
- 14.6 *Normally*, the vendor can direct the purchaser to produce a *settlement cheque* on completion to pay an amount adjustable under this contract and if so –
- 14.6.1 the amount is to be treated as if it were paid; and
- 14.6.2 the *cheque* must be forwarded to the payee immediately after completion (by the purchaser if the *cheque* relates only to the *property* or by the vendor in any other case).
- 14.7 If on completion the last bill for a water, sewerage or drainage usage charge is for a period ending before the *adjustment date*, the vendor is liable for an amount calculated by dividing the bill by the number of days in the period then multiplying by the number of unbilled days up to and including the *adjustment date*.
- 14.8 The vendor is liable for any amount recoverable for work started on or before the contract date on the *property* or any adjoining footpath or road.

#### 15 Date for completion

The *parties* must complete by the date for completion and, if they do not, a *party* can *serve* a notice to complete if that *party* is otherwise entitled to do so.

#### 16 Completion

##### • Vendor

- 16.1 On completion the vendor must give the purchaser any *document of title* that relates only to the *property*.
- 16.2 If on completion the vendor has possession or control of a *document of title* that relates also to other property, the vendor must produce it as and where necessary.
- 16.3 *Normally*, on completion the vendor must cause the legal title to the *property* (being an estate in fee simple) to pass to the purchaser free of any mortgage or other interest, subject to any necessary registration.
- 16.4 The legal title to the *property* does not pass before completion.

- 16.5 If the vendor gives the purchaser a document (other than the transfer) that needs to be lodged for registration, the vendor must pay the lodgment fee to the purchaser.
- 16.6 If a *party serves* a land tax certificate showing a charge on any of the land, by completion the vendor must do all things and pay all money required so that the charge is no longer effective against the land.
- **Purchaser**
- 16.7 On completion the purchaser must pay to the vendor, by cash (up to \$2,000) or *settlement cheque* –
- 16.7.1 the price less any:
- deposit paid;
  - *FRCGW remittance payable*;
  - *GSTRW payment*; and
  - amount payable by the vendor to the purchaser under this contract; and
- 16.7.2 any other amount payable by the purchaser under this contract.
- 16.8 If the vendor requires more than 5 *settlement cheques*, the vendor must pay \$10 for each extra *cheque*.
- 16.9 If any of the deposit is not covered by a bond or guarantee, on completion the purchaser must give the vendor an order signed by the purchaser authorising the *depositholder* to account to the vendor for the deposit.
- 16.10 On completion the deposit belongs to the vendor.
- **Place for completion**
- 16.11 *Normally*, the *parties* must complete at the completion address, which is –
- 16.11.1 if a special completion address is stated in this contract - that address; or
- 16.11.2 if none is stated, but a first mortgagee is disclosed in this contract and the mortgagee would usually discharge the mortgage at a particular place - that place; or
- 16.11.3 in any other case - the vendor's *solicitor's* address stated in this contract.
- 16.12 The vendor by reasonable notice can require completion at another place, if it is in NSW, but the vendor must pay the purchaser's additional expenses, including any agency or mortgagee fee.
- 16.13 If the purchaser requests completion at a place that is not the completion address, and the vendor agrees, the purchaser must pay the vendor's additional expenses, including any agency or mortgagee fee.
- 17 Possession**
- 17.1 *Normally*, the vendor must give the purchaser vacant possession of the *property* on completion.
- 17.2 The vendor does not have to give vacant possession if –
- 17.2.1 this contract says that the sale is subject to existing tenancies; and
- 17.2.2 the contract discloses the provisions of the tenancy (for example, by attaching a copy of the lease and any relevant memorandum or variation)
- 17.3 *Normally*, the purchaser can claim compensation (before or after completion) or *rescind* if any of the land is affected by a protected tenancy (a tenancy affected by Schedule 2, Part 7 of the Residential Tenancies Act 2010).
- 18 Possession before completion**
- 18.1 This clause applies only if the vendor gives the purchaser possession of the *property* before completion.
- 18.2 The purchaser must not before completion –
- 18.2.1 let or part with possession of any of the *property*;
- 18.2.2 make any change or structural alteration or addition to the *property*; or
- 18.2.3 contravene any agreement between the *parties* or any direction, document, *legislation*, notice or order affecting the *property*.
- 18.3 The purchaser must until completion –
- 18.3.1 keep the *property* in good condition and repair having regard to its condition at the giving of possession; and
- 18.3.2 allow the vendor or the vendor's authorised representative to enter and inspect it at all reasonable times.
- 18.4 The risk as to damage to the *property* passes to the purchaser immediately after the purchaser enters into possession.
- 18.5 If the purchaser does not comply with this clause, then without affecting any other right of the vendor –
- 18.5.1 the vendor can before completion, without notice, remedy the non-compliance; and
- 18.5.2 if the vendor pays the expense of doing this, the purchaser must pay it to the vendor with interest at the rate prescribed under s101 Civil Procedure Act 2005.
- 18.6 If this contract is *rescinded* or *terminated* the purchaser must immediately vacate the *property*.
- 18.7 If the *parties* or their *solicitors* on their behalf do not agree in writing to a fee or rent, none is payable.
- 19 Rescission of contract**
- 19.1 If this contract expressly gives a *party* a right to *rescind*, the *party* can exercise the right –
- 19.1.1 only by *servicing* a notice before completion; and
- 19.1.2 in spite of any making of a claim or *requisition*, any attempt to satisfy a claim or *requisition*, any arbitration, litigation, mediation or negotiation or any giving or taking of possession.
- 19.2 *Normally*, if a *party* exercises a right to *rescind* expressly given by this contract or any *legislation* –
- 19.2.1 the deposit and any other money paid by the purchaser under this contract must be refunded;
- 19.2.2 a *party* can claim for a reasonable adjustment if the purchaser has been in possession;
- 19.2.3 a *party* can claim for damages, costs or expenses arising out of a breach of this contract; and
- 19.2.4 a *party* will not otherwise be liable to pay the other *party* any damages, costs or expenses.

**20 Miscellaneous**

- 20.1 The *parties* acknowledge that anything stated in this contract to be attached was attached to this contract by the vendor before the purchaser signed it and is part of this contract.
- 20.2 Anything attached to this contract is part of this contract.
- 20.3 An area, bearing or dimension in this contract is only approximate.
- 20.4 If a *party* consists of 2 or more persons, this contract benefits and binds them separately and together.
- 20.5 A *party's solicitor* can receive any amount payable to the *party* under this contract or direct in writing that it is to be paid to another person.
- 20.6 A document under or relating to this contract is –
- 20.6.1 signed by a *party* if it is signed by the *party* or the *party's solicitor* (apart from a direction under clause 4.3);
- 20.6.2 served if it is served by the *party* or the *party's solicitor*;
- 20.6.3 served if it is served on the *party's solicitor*, even if the *party* has died or any of them has died;
- 20.6.4 served if it is served in any manner provided in s170 of the Conveyancing Act 1919;
- 20.6.5 served if it is sent by email or fax to the *party's solicitor*, unless in either case it is not received;
- 20.6.6 served on a person if it (or a copy of it) comes into the possession of the person; and
- 20.6.7 served at the earliest time it is served, if it is served more than once.
- 20.7 An obligation to pay an expense of another *party* of doing something is an obligation to pay –
- 20.7.1 if the *party* does the thing personally - the reasonable cost of getting someone else to do it; or
- 20.7.2 if the *party* pays someone else to do the thing - the amount paid, to the extent it is reasonable.
- 20.8 Rights under clauses 11, 13, 14, 17, 24, 30 and 31 continue after completion, whether or not other rights continue.
- 20.9 The vendor does not promise, represent or state that the purchaser has any cooling off rights.
- 20.10 The vendor does not promise, represent or state that any attached survey report is accurate or current.
- 20.11 A reference to any *legislation* (including any percentage or rate specified in *legislation*) is also a reference to any corresponding later *legislation*.
- 20.12 Each *party* must do whatever is necessary after completion to carry out the *party's* obligations under this contract.
- 20.13 Neither taking possession nor *servicing* a transfer of itself implies acceptance of the *property* or the title.
- 20.14 The details and information provided in this contract (for example, on pages 1 - 3) are, to the extent of each *party's* knowledge, true, and are part of this contract.
- 20.15 Where this contract provides for choices, a choice in BLOCK CAPITALS applies unless a different choice is marked.

**21 Time limits in these provisions**

- 21.1 If the time for something to be done or to happen is not stated in these provisions, it is a reasonable time.
- 21.2 If there are conflicting times for something to be done or to happen, the latest of those times applies.
- 21.3 The time for one thing to be done or to happen does not extend the time for another thing to be done or to happen.
- 21.4 If the time for something to be done or to happen is the 29th, 30th or 31st day of a month, and the day does not exist, the time is instead the last day of the month.
- 21.5 If the time for something to be done or to happen is a day that is not a *business day*, the time is extended to the next *business day*, except in the case of clauses 2 and 3.2.
- 21.6 *Normally*, the time by which something must be done is fixed but not essential.

**22 Foreign Acquisitions and Takeovers Act 1975**

- 22.1 The purchaser promises that the Commonwealth Treasurer cannot prohibit and has not prohibited the transfer under the Foreign Acquisitions and Takeovers Act 1975.
- 22.2 This promise is essential and a breach of it entitles the vendor to *terminate*.

**23 Strata or community title****• Definitions and modifications**

- 23.1 This clause applies only if the land (or part of it) is a lot in a strata, neighbourhood, precinct or community scheme (or on completion is to be a lot in a scheme of that kind).
- 23.2 In this contract –
- 23.2.1 'change', in relation to a scheme, means –
- a registered or registrable change from by-laws set out in this contract;
  - a change from a development or management contract or statement set out in this contract; or
  - a change in the boundaries of common property;
- 23.2.2 'common property' includes association property for the scheme or any higher scheme;
- 23.2.3 'contribution' includes an amount payable under a by-law;
- 23.2.4 'information certificate' includes a certificate under s184 Strata Schemes Management Act 2015 and s26 Community Land Management Act 1989;
- 23.2.5 'information notice' includes a strata information notice under s22 Strata Schemes Management Act 2015 and a notice under s47 Community Land Management Act 1989;

- 23.2.6 'normal expenses', in relation to an owners corporation for a scheme, means normal operating expenses usually payable from the administrative fund of an owners corporation for a scheme of the same kind;
- 23.2.7 'owners corporation' means the owners corporation or the association for the scheme or any higher scheme;
- 23.2.8 'the *property*' includes any interest in common property for the scheme associated with the lot; and
- 23.2.9 'special expenses', in relation to an owners corporation, means its actual, contingent or expected expenses, except to the extent they are –
- normal expenses;
  - due to fair wear and tear;
  - disclosed in this contract; or
  - covered by moneys held in the capital works fund.
- 23.3 Clauses 11, 14.8 and 18.4 do not apply to an obligation of the owners corporation, or to property insurable by it.
- 23.4 Clauses 14.4.2 and 14.5 apply but on a unit entitlement basis instead of an area basis.
- **Adjustments and liability for expenses**
- 23.5 The *parties* must adjust under clause 14.1 –
- 23.5.1 a regular periodic contribution;
- 23.5.2 a contribution which is not a regular periodic contribution but is disclosed in this contract; and
- 23.5.3 on a unit entitlement basis, any amount paid by the vendor for a normal expense of the owners corporation to the extent the owners corporation has not paid the amount to the vendor.
- 23.6 If a contribution is not a regular periodic contribution and is not disclosed in this contract –
- 23.6.1 the vendor is liable for it if it was determined on or before the contract date, even if it is payable by instalments; and
- 23.6.2 the purchaser is liable for all contributions determined after the contract date.
- 23.7 The vendor must pay or allow to the purchaser on completion the amount of any unpaid contributions for which the vendor is liable under clause 23.6.1.
- 23.8 *Normally*, the purchaser cannot make a claim or *requisition* or *rescind* or *terminate* in respect of –
- 23.8.1 an existing or future actual, contingent or expected expense of the owners corporation;
- 23.8.2 a proportional unit entitlement of the lot or a relevant lot or former lot, apart from a claim under clause 6; or
- 23.8.3 a past or future change in the scheme or a higher scheme.
- 23.9 However, the purchaser can *rescind* if –
- 23.9.1 the special expenses of the owners corporation at the later of the contract date and the creation of the owners corporation when calculated on a unit entitlement basis (and, if more than one lot or a higher scheme is involved, added together), less any contribution paid by the vendor, are more than 1% of the price;
- 23.9.2 in the case of the lot or a relevant lot or former lot in a higher scheme, a proportional unit entitlement for the lot is disclosed in this contract but the lot has a different proportional unit entitlement at the contract date or at any time before completion;
- 23.9.3 a change before the contract date or before completion in the scheme or a higher scheme materially prejudices the purchaser and is not disclosed in this contract; or
- 23.9.4 a resolution is passed by the owners corporation before the contract date or before completion to give to the owners in the scheme for their consideration a strata renewal plan that has not lapsed at the contract date and there is not attached to this contract a strata renewal proposal or the strata renewal plan.
- **Notices, certificates and inspections**
- 23.10 The purchaser must give the vendor 2 copies of an information notice addressed to the owners corporation and signed by the purchaser.
- 23.11 The vendor must complete and sign 1 copy of the notice and give it to the purchaser on completion.
- 23.12 Each *party* can sign and give the notice as agent for the other.
- 23.13 The vendor must *serve* an information certificate issued after the contract date in relation to the lot, the scheme or any higher scheme at least 7 days before the date for completion.
- 23.14 The purchaser does not have to complete earlier than 7 days after *service* of the certificate and clause 21.3 does not apply to this provision. On completion the purchaser must pay the vendor the prescribed fee for the certificate.
- 23.15 The vendor authorises the purchaser to apply for the purchaser's own certificate.
- 23.16 The vendor authorises the purchaser to apply for and make an inspection of any record or other document in the custody or control of the owners corporation or relating to the scheme or any higher scheme.
- **Meetings of the owners corporation**
- 23.17 If a general meeting of the owners corporation is convened before completion –
- 23.17.1 if the vendor receives notice of it, the vendor must immediately notify the purchaser of it; and
- 23.17.2 after the expiry of any cooling off period, the purchaser can require the vendor to appoint the purchaser (or the purchaser's nominee) to exercise any voting rights of the vendor in respect of the lot at the meeting.

**24 Tenancies**

- 24.1 If a tenant has not made a payment for a period preceding or current at the *adjustment date* –
- 24.1.1 for the purposes of clause 14.2, the amount is to be treated as if it were paid; and
- 24.1.2 the purchaser assigns the debt to the vendor on completion and will if required give a further assignment at the vendor's expense.
- 24.2 If a tenant has paid in advance of the *adjustment date* any periodic payment in addition to rent, it must be adjusted as if it were rent for the period to which it relates.
- 24.3 If the *property* is to be subject to a tenancy on completion or is subject to a tenancy on completion –
- 24.3.1 the vendor authorises the purchaser to have any accounting records relating to the tenancy inspected and audited and to have any other document relating to the tenancy inspected;
- 24.3.2 the vendor must *serve* any information about the tenancy reasonably requested by the purchaser before or after completion; and
- 24.3.3 *normally*, the purchaser can claim compensation (before or after completion) if –
- a disclosure statement required by the Retail Leases Act 1994 was not given when required;
  - such a statement contained information that was materially false or misleading;
  - a provision of the lease is not enforceable because of a non-disclosure in such a statement; or
  - the lease was entered into in contravention of the Retail Leases Act 1994.
- 24.4 If the *property* is subject to a tenancy on completion –
- 24.4.1 the vendor must allow or transfer –
- any remaining bond money or any other security against the tenant's default (to the extent the security is transferable);
  - any money in a fund established under the lease for a purpose and compensation for any money in the fund or interest earned by the fund that has been applied for any other purpose; and
  - any money paid by the tenant for a purpose that has not been applied for that purpose and compensation for any of the money that has been applied for any other purpose;
- 24.4.2 if the security is not transferable, each *party* must do everything reasonable to cause a replacement security to issue for the benefit of the purchaser and the vendor must hold the original security on trust for the benefit of the purchaser until the replacement security issues;
- 24.4.3 the vendor must give to the purchaser –
- a proper notice of the transfer (an attornment notice) addressed to the tenant;
  - any certificate given under the Retail Leases Act 1994 in relation to the tenancy;
  - a copy of any disclosure statement given under the Retail Leases Act 1994;
  - a copy of any document served on the tenant under the lease and written details of its service, if the document concerns the rights of the landlord or the tenant after completion; and
  - any document served by the tenant under the lease and written details of its service, if the document concerns the rights of the landlord or the tenant after completion;
- 24.4.4 the vendor must comply with any obligation to the tenant under the lease, to the extent it is to be complied with by completion; and
- 24.4.5 the purchaser must comply with any obligation to the tenant under the lease, to the extent that the obligation is disclosed in this contract and is to be complied with after completion.

**25 Qualified title, limited title and old system title**

- 25.1 This clause applies only if the land (or part of it) –
- 25.1.1 is under qualified, limited or old system title; or
- 25.1.2 on completion is to be under one of those titles.
- 25.2 The vendor must *serve* a proper abstract of title *within* 7 days after the contract date.
- 25.3 If an abstract of title or part of an abstract of title is attached to this contract or has been lent by the vendor to the purchaser before the contract date, the abstract or part is *served* on the contract date.
- 25.4 An abstract of title can be or include a list of documents, events and facts arranged (apart from a will or codicil) in date order, if the list in respect of each document –
- 25.4.1 shows its date, general nature, names of parties and any registration number; and
- 25.4.2 has attached a legible photocopy of it or of an official or registration copy of it.
- 25.5 An abstract of title –
- 25.5.1 must start with a good root of title (if the good root of title must be at least 30 years old, this means 30 years old at the contract date);
- 25.5.2 in the case of a leasehold interest, must include an abstract of the lease and any higher lease;
- 25.5.3 *normally*, need not include a Crown grant; and
- 25.5.4 need not include anything evidenced by the Register kept under the Real Property Act 1900.
- 25.6 In the case of land under old system title –
- 25.6.1 in this contract 'transfer' means conveyance;
- 25.6.2 the purchaser does not have to *serve* the form of transfer until after the vendor has *served* a proper abstract of title; and
- 25.6.3 each vendor must give proper covenants for title as regards that vendor's interest.
- 25.7 In the case of land under limited title but not under qualified title –

- 25.7.1 normally, the abstract of title need not include any document which does not show the location, area or dimensions of the land (for example, by including a metes and bounds description or a plan of the land);
- 25.7.2 clause 25.7.1 does not apply to a document which is the good root of title; and
- 25.7.3 the vendor does not have to provide an abstract if this contract contains a delimitation plan (whether in registrable form or not).
- 25.8 The vendor must give a proper covenant to produce where relevant.
- 25.9 The vendor does not have to produce or covenant to produce a document that is not in the possession of the vendor or a mortgagee.
- 25.10 If the vendor is unable to produce an original document in the chain of title, the purchaser will accept a photocopy from the Registrar-General of the registration copy of that document.
- 26 Crown purchase money**
- 26.1 This clause applies only if purchase money is payable to the Crown, whether or not due for payment.
- 26.2 The vendor is liable for the money, except to the extent this contract says the purchaser is liable for it.
- 26.3 To the extent the vendor is liable for it, the vendor is liable for any interest until completion.
- 26.4 To the extent the purchaser is liable for it, the *parties* must adjust any interest under clause 14.1.
- 27 Consent to transfer**
- 27.1 This clause applies only if the land (or part of it) cannot be transferred without consent under *legislation* or a *planning agreement*.
- 27.2 The purchaser must properly complete and then *serve* the purchaser's part of an application for consent to transfer of the land (or part of it) *within 7 days* after the contract date.
- 27.3 The vendor must apply for consent *within 7 days* after *service* of the purchaser's part.
- 27.4 If consent is refused, either *party* can *rescind*.
- 27.5 If consent is given subject to one or more conditions that will substantially disadvantage a *party*, then that *party* can *rescind* *within 7 days* after receipt by or *service* upon the *party* of written notice of the conditions.
- 27.6 If consent is not given or refused –
- 27.6.1 *within 42 days* after the purchaser *serves* the purchaser's part of the application, the purchaser can *rescind*; or
- 27.6.2 *within 30 days* after the application is made, either *party* can *rescind*.
- 27.7 Each period in clause 27.6 becomes 90 days if the land (or part of it) is –
- 27.7.1 under a *planning agreement*; or
- 27.7.2 in the Western Division.
- 27.8 If the land (or part of it) is described as a lot in an unregistered plan, each time in clause 27.6 becomes the later of the time and 35 days after creation of a separate folio for the lot.
- 27.9 The date for completion becomes the later of the date for completion and 14 days after *service* of the notice granting consent to transfer.
- 28 Unregistered plan**
- 28.1 This clause applies only if some of the land is described as a lot in an unregistered plan.
- 28.2 The vendor must do everything reasonable to have the plan registered *within 6 months* after the contract date, with or without any minor alteration to the plan or any document to be lodged with the plan validly required or made under *legislation*.
- 28.3 If the plan is not registered *within* that time and in that manner –
- 28.3.1 the purchaser can *rescind*; and
- 28.3.2 the vendor can *rescind*, but only if the vendor has complied with clause 28.2 and with any *legislation* governing the rescission.
- 28.4 Either *party* can *serve* notice of the registration of the plan and every relevant lot and plan number.
- 28.5 The date for completion becomes the later of the date for completion and 21 days after *service* of the notice.
- 28.6 Clauses 28.2 and 28.3 apply to another plan that is to be registered before the plan is registered.
- 29 Conditional contract**
- 29.1 This clause applies only if a provision says this contract or completion is conditional on an event.
- 29.2 If the time for the event to happen is not stated, the time is 42 days after the contract date.
- 29.3 If this contract says the provision is for the benefit of a *party*, then it benefits only that *party*.
- 29.4 If anything is necessary to make the event happen, each *party* must do whatever is reasonably necessary to cause the event to happen.
- 29.5 A *party* can *rescind* under this clause only if the *party* has substantially complied with clause 29.4.
- 29.6 If the event involves an approval and the approval is given subject to a condition that will substantially disadvantage a *party* who has the benefit of the provision, the *party* can *rescind* *within 7 days* after either *party* *serves* notice of the condition.
- 29.7 If the *parties* can lawfully complete without the event happening –
- 29.7.1 if the event does not happen *within* the time for it to happen, a *party* who has the benefit of the provision can *rescind* *within 7 days* after the end of that time;
- 29.7.2 if the event involves an approval and an application for the approval is refused, a *party* who has the benefit of the provision can *rescind* *within 7 days* after either *party* *serves* notice of the refusal; and



- 29.7.3 the date for completion becomes the later of the date for completion and 21 days after the earliest of –
- either *party serving* notice of the event happening;
  - every *party* who has the benefit of the provision *serving* notice waiving the provision; or
  - the end of the time for the event to happen.
- 29.8 If the *parties* cannot lawfully complete without the event happening –
- 29.8.1 if the event does not happen *within* the time for it to happen, either *party* can *rescind*;
- 29.8.2 if the event involves an approval and an application for the approval is refused, either *party* can *rescind*;
- 29.8.3 the date for completion becomes the later of the date for completion and 21 days after either *party* *serves* notice of the event happening.
- 29.9 A *party* cannot *rescind* under clauses 29.7 or 29.8 after the event happens.
- 30 Electronic transaction**
- 30.1 This *Conveyancing Transaction* is to be conducted as an *electronic transaction* if –
- 30.1.1 this contract says that it is an *electronic transaction*;
- 30.1.2 the *parties* otherwise agree that it is to be conducted as an *electronic transaction*; or
- 30.1.3 the *conveyancing rules* require it to be conducted as an *electronic transaction*.
- 30.2 However, this *Conveyancing Transaction* is not to be conducted as an *electronic transaction* –
- 30.2.1 if the land is not *electronically tradeable* or the transfer is not eligible to be lodged electronically; or
- 30.2.2 if, at any time after the *effective date*, but at least 14 days before the date for completion, a *party* *serves* a notice stating a valid reason why it cannot be conducted as an *electronic transaction*.
- 30.3 If, because of clause 30.2.2, this *Conveyancing Transaction* is not to be conducted as an *electronic transaction* –
- 30.3.1 each *party* must –
- bear equally any disbursements or fees; and
  - otherwise bear that *party's* own costs;
- incurred because this *Conveyancing Transaction* was to be conducted as an *electronic transaction*; and
- 30.3.2 if a *party* has paid all of a disbursement or fee which, by reason of this clause, is to be borne equally by the *parties*, that amount must be adjusted under clause 14.2.
- 30.4 If this *Conveyancing Transaction* is to be conducted as an *electronic transaction* –
- 30.4.1 to the extent that any other provision of this contract is inconsistent with this clause, the provisions of this clause prevail;
- 30.4.2 *normally*, words and phrases used in this clause 30 (italicised and in Title Case, such as *Electronic Workspace* and *Lodgment Case*) have the same meaning which they have in the *participation rules*;
- 30.4.3 the *parties* must conduct the *electronic transaction* –
- in accordance with the *participation rules* and the *ECNL*; and
  - using the nominated *ELN*, unless the *parties* otherwise agree;
- 30.4.4 a *party* must pay the fees and charges payable by that *party* to the *ELNO* and the *Land Registry* as a result of this transaction being an *electronic transaction*;
- 30.4.5 any communication from one *party* to another *party* in the *Electronic Workspace* made –
- after the *effective date*; and
  - before the receipt of a notice given under clause 30.2.2;
- is taken to have been received by that *party* at the time determined by s13A of the *Electronic Transactions Act 2000*; and
- 30.4.6 a document which is an *electronic document* is *served* as soon as it is first *Digitally Signed* in the *Electronic Workspace* on behalf of the *party* required to *serve* it.
- 30.5 *Normally*, the vendor must *within 7 days* of the *effective date* –
- 30.5.1 create an *Electronic Workspace*;
- 30.5.2 *populate* the *Electronic Workspace* with *title data*, the date for completion and, if applicable, *mortgagee details*; and
- 30.5.3 invite the purchaser and any *discharging mortgagee* to the *Electronic Workspace*.
- 30.6 If the vendor has not created an *Electronic Workspace* in accordance with clause 30.5, the purchaser may create an *Electronic Workspace*. If the purchaser creates the *Electronic Workspace* the purchaser must –
- 30.6.1 *populate* the *Electronic Workspace* with *title data*;
- 30.6.2 create and *populate* an *electronic transfer*;
- 30.6.3 *populate* the *Electronic Workspace* with the date for completion and a nominated *completion time*; and
- 30.6.4 invite the vendor and any *incoming mortgagee* to join the *Electronic Workspace*.
- 30.7 *Normally*, *within 7 days* of receiving an invitation from the vendor to join the *Electronic Workspace*, the purchaser must –
- 30.7.1 join the *Electronic Workspace*;
- 30.7.2 create and *populate* an *electronic transfer*;
- 30.7.3 invite any *incoming mortgagee* to join the *Electronic Workspace*; and
- 30.7.4 *populate* the *Electronic Workspace* with a nominated *completion time*.

- 30.8 If the purchaser has created the *Electronic Workspace* the vendor must *within 7 days* of being invited to the *Electronic Workspace* –
- 30.8.1 join the *Electronic Workspace*;
- 30.8.2 *populate* the *Electronic Workspace* with *mortgagee details*, if applicable; and
- 30.8.3 invite any *discharging mortgagee* to join the *Electronic Workspace*.
- 30.9 To complete the financial settlement schedule in the *Electronic Workspace* –
- 30.9.1 the purchaser must provide the vendor with *adjustment figures* at least *2 business days* before the date for completion;
- 30.9.2 the vendor must confirm the *adjustment figures* at least *1 business day* before the date for completion; and
- 30.9.3 if the purchaser must make a *GSTRW payment* or an *FRCGW remittance*, the purchaser must *populate* the *Electronic Workspace* with the payment details for the *GSTRW payment* or *FRCGW remittance* payable to the Deputy Commissioner of Taxation at least *2 business days* before the date for completion.
- 30.10 Before completion, the *parties* must ensure that –
- 30.10.1 all *electronic documents* which a *party* must *Digitally Sign* to complete the *electronic transaction* are *populated* and *Digitally Signed*;
- 30.10.2 all certifications required by the *ECNL* are properly given; and
- 30.10.3 they do everything else in the *Electronic Workspace* which that *party* must do to enable the *electronic transaction* to proceed to completion.
- 30.11 If completion takes place in the *Electronic Workspace* –
- 30.11.1 payment electronically on completion of the price in accordance with clause 16.7 is taken to be payment by a single *settlement cheque*;
- 30.11.2 the completion address in clause 16.11 is the *Electronic Workspace*; and
- 30.11.3 clauses 13.13.2 to 13.13.4, 16.8, 16.12, 16.13 and 31.2.2 to 31.2.4 do not apply.
- 30.12 If the computer systems of any of the *Land Registry*, the *ELNO* or the Reserve Bank of Australia are inoperative for any reason at the *completion time* agreed by the *parties*, a failure to complete this contract for that reason is not a default under this contract on the part of either *party*.
- 30.13 If the computer systems of the *Land Registry* are inoperative for any reason at the *completion time* agreed by the *parties*, and the *parties* choose that financial settlement is to occur despite this, then on financial settlement occurring –
- 30.13.1 all *electronic documents Digitally Signed* by the vendor, the *certificate of title* and any discharge of mortgage, withdrawal of caveat or other *electronic document* forming part of the *Lodgment Case* for the *electronic transaction* shall be taken to have been unconditionally and irrevocably delivered to the purchaser or the purchaser's mortgagee at the time of financial settlement together with the right to deal with the land comprised in the *certificate of title*; and
- 30.13.2 the vendor shall be taken to have no legal or equitable interest in the *property*.
- 30.14 A *party* who holds a *certificate of title* must act in accordance with any *Prescribed Requirement* in relation to the *certificate of title* but if there is no *Prescribed Requirement*, the vendor must *serve* the *certificate of title* after completion.
- 30.15 If the *parties* do not agree about the delivery before completion of one or more documents or things that cannot be delivered through the *Electronic Workspace*, the *party* required to deliver the documents or things –
- 30.15.1 holds them on completion in escrow for the benefit of; and
- 30.15.2 must immediately after completion deliver the documents or things to, or as directed by; the *party* entitled to them.
- 30.16 In this clause 30, these terms (in any form) mean –
- |                              |   |
|------------------------------|---|
| <i>adjustment figures</i>    | details of the adjustments to be made to the price under clause 14;   |
| <i>certificate of title</i>  | the paper duplicate of the folio of the register for the land which exists immediately prior to completion and, if more than one, refers to each such paper duplicate;  |
| <i>completion time</i>       | the time of day on the date for completion when the <i>electronic transaction</i> is to be settled;   |
| <i>conveyancing rules</i>    | the rules made under s12E of the Real Property Act 1900;  |
| <i>discharging mortgagee</i> | any discharging mortgagee, chargee, covenant chargee or caveator whose provision of a <i>Digitally Signed</i> discharge of mortgage, discharge of charge or withdrawal of caveat is required in order for unencumbered title to the <i>property</i> to be transferred to the purchaser; |
| <i>ECNL</i>                  | the Electronic Conveyancing National Law (NSW);   |
| <i>effective date</i>        | the date on which the <i>Conveyancing Transaction</i> is agreed to be an <i>electronic transaction</i> under clause 30.1.2 or, if clauses 30.1.1 or 30.1.3 apply, the contract date;  |
| <i>electronic document</i>   | a dealing as defined in the Real Property Act 1900 which may be created and <i>Digitally Signed</i> in an <i>Electronic Workspace</i> ;   |
| <i>electronic transfer</i>   | a transfer of land under the Real Property Act 1900 for the <i>property</i> to be prepared and <i>Digitally Signed</i> in the <i>Electronic Workspace</i> established for the purposes of the <i>parties' Conveyancing Transaction</i> ;  |

<i>electronic transaction</i>	a <i>Conveyancing Transaction</i> to be conducted for the <i>parties</i> by their legal representatives as <i>Subscribers</i> using an <i>ELN</i> and in accordance with the <i>ECNL</i> and the <i>participation rules</i> ;
<i>electronically tradeable</i>	a land title that is Electronically Tradeable as that term is defined in the <i>conveyancing rules</i> ;
<i>incoming mortgagee</i>	any mortgagee who is to provide finance to the purchaser on the security of the <i>property</i> and to enable the purchaser to pay the whole or part of the price;
<i>mortgagee details</i>	the details which a <i>party</i> to the <i>electronic transaction</i> must provide about any <i>discharging mortgagee</i> of the <i>property</i> as at completion;
<i>participation rules</i>	the participation rules as determined by the <i>ECNL</i> ;
<i>populate</i>	to complete data fields in the <i>Electronic Workspace</i> ; and
<i>title data</i>	the details of the title to the <i>property</i> made available to the <i>Electronic Workspace</i> by the <i>Land Registry</i> .

### 31 Foreign Resident Capital Gains Withholding

- 31.1 This clause applies only if –
- 31.1.1 the sale is not an excluded transaction within the meaning of s14-215 of Schedule 1 to the *TA Act*; and
- 31.1.2 a *clearance certificate* in respect of every vendor is not attached to this contract.
- 31.2 The purchaser must –
- 31.2.1 at least 5 days before the date for completion, *serve* evidence of submission of a purchaser payment notification to the Australian Taxation Office by the purchaser or, if a direction under clause 4.3 has been *served*, by the transferee named in the transfer *served* with that direction;
- 31.2.2 produce on completion a *settlement cheque* for the *FRCGW remittance* payable to the Deputy Commissioner of Taxation;
- 31.2.3 forward the *settlement cheque* to the payee immediately after completion; and
- 31.2.4 *serve* evidence of receipt of payment of the *FRCGW remittance*.
- 31.3 The vendor cannot refuse to complete if the purchaser complies with clauses 31.2.1 and 31.2.2.
- 31.4 If the vendor *serves* any *clearance certificate* or *variation*, the purchaser does not have to complete earlier than 7 days after that *service* and clause 21.3 does not apply to this provision.
- 31.5 If the vendor *serves* in respect of every vendor either a *clearance certificate* or a *variation* to 0.00 percent, clauses 31.2 and 31.3 do not apply.

### 32 Residential off the plan contract

- 32.1 This clause applies if this contract is an off the plan contract within the meaning of Division 10 of Part 4 of the Conveyancing Act 1919 (the Division).
- 32.2 No provision of this contract has the effect of excluding, modifying or restricting the operation of the Division.
- 32.3 If the purchaser makes a claim for compensation under the terms prescribed by clause 6A of the Conveyancing (Sale of Land) Regulation 2017 –
- 32.3.1 the purchaser cannot make a claim under this contract about the same subject matter, including a claim under clauses 6 or 7; and
- 32.3.2 the claim for compensation is not a claim under this contract.
- 32.4 This clause does not apply to a contract made before the commencement of the amendments to the Division under the Conveyancing Legislation Amendment Act 2018.

**Central Coast Conveyancing Firm**  
**Property ; 4/27 Brougham Street, East Gosford**  
**Vendor; Catherine Anne Low**

The terms of the printed Contract annexed shall be read subject to the following additional conditions. If there is a conflict between these additional conditions and the printed Contract then these additional conditions shall prevail. The parties to the Contract agree that should any provision be held to be contrary to law, void or unenforceable, then such provision shall be severed from this Contract and such remaining provisions shall remain in full force and effect.

**ADDITIONAL CONDITIONS**

**32. Amendment to Printed Form**

The printed form of contract is amended as follows:-

- a) Clause 7.1.1 is amended to read "1%" in lieu of "5%"
- b) Clause 14.4.2 is deleted
- c) Clause 16.12 delete words "but the vendor must pay the purchaser's additional expenses, including any agency or mortgagee fee"
- d) Clause 18 is amended by the addition of:  
 "18.8 The Purchaser cannot make a claim, requisition or delay settlement after entering into possession of the property."
- e) Clause 23.13 – is amended by deleting "at least 7 days before the date for completion."
- f) Clause 23.14 is amended by deleting the first sentence
- g) Clause 30.16 – effective date definition is amended by deleting "the contract date" and replacing with "the Contract is unconditionally exchanged"
- h) Clause 31.4 is deleted

**33. Adjustments**

The parties agree to adjust all usual outgoings under the Contract on completion excluding postponed rates, however, if any amount is incorrectly calculated or overlooked the parties agree to correct such error and to reimburse each other accordingly after settlement. This clause shall not merge on completion.

**34. Death and Disability**

Without negating limiting or restricting any rights or remedies available to either party at law or in equity had this clause not been included, should either party (or, where the party comprises more than one person, any of them) prior to completion:

- a) die or become mentally ill then either party can rescind this Contract whereupon the provisions of Clause 19 shall apply; or
- b) be declared bankrupt or, being a company, go into liquidation or be served a petition for its winding up or enter into any scheme of arrangement with its creditors or have a liquidator, receiver or official manager of it appointed, then the other party can rescind this Contract whereupon Clause 19 of the Contract shall apply.

**35. Vendors' Selling Agent**

The purchaser warrants that he was not introduced to the subject property by any licensed real estate agent other than the agent noted in this contract for sale. The purchaser indemnifies the vendor from and against the payment of all commission that may be found to be payable on this sale to any real estate agent, other than the agent noted in this contract, through breach of this warranty. The purchaser warrants to further indemnify the vendor against any related legal costs incurred as a result of any commission claim. This condition shall not merge on completion.

**36. Notice to Complete**

A party is entitled to issue a notice to complete from 5pm on the completion date and the parties agree that fourteen (14) days after service shall be sufficient as to time allowed for completion provided always the notice may be withdrawn at any time without prejudice to the continuing rights to give a further notice pursuant to this contract/condition.

Should tenants be in occupation at the date of exchange and completion be delayed via the vendor's inability to provide vacant possession due to the fault of existing tenants then both parties agree that 28 days Notice to Complete shall be a reasonable time to provide a sufficient period to allow the vendor to use all available methods available at law to provide such vacant possession.

**Central Coast Conveyancing Firm**  
**Property ; 4/27 Brougham Street, East Gosford**  
**Vendor; Catherine Anne Low**

If the vendor is entitled and serves a Notice to Complete, the purchaser shall allow on completion the costs of the vendor incurred in the issue of the notice in the sum of \$330.00 (inclusive of GST). The payment of the costs of Notice upon Completion shall be an essential term of this contract.

**37. Default Interest**

If the purchaser does not complete this contract by the completion date, without default by the vendor, the purchaser shall pay to the vendor on completion, in addition to the balance purchase money, an amount calculated as eight per cent (8%) per annum interest on the balance of purchase price, computed at a daily rate from the day immediately after the completion date to the day on which this sale shall be completed.

The parties agree that this amount is a genuine pre- estimate for the vendor's loss of interest for the purchase money and liability for rates and outgoings and notwithstanding any other provisions herein the vendor's obligation to transfer title of the property to the purchaser will be dependent upon payment of such interest (if any).

**38. Condition of the Property**

The purchaser acknowledges having the opportunity to inspect the property and agrees to purchase the property in its present state and condition subject to all defects patent and latent and any infestation or dilapidation, notwithstanding anything to the contrary contained or implied, and the purchaser shall make no objection requisition or claim for compensation in respect thereof.

**39. Particulars of Title**

A sufficient statement of the Vendor's title shall be deemed included in the description of the property hereinbefore appearing and such statement shall have been deemed to have been given to the Purchaser as at the date hereof.

**40. Split deposit**

In the event that this contract is exchanged under the provisions of Section 66S (cooling off period), the deposit referred to on the front particulars page shall be paid by the purchaser as follows:-

- (a) 0.25% of the purchase price on the date this contract was made; and
- (b) The remainder of the 10% deposit at any time before 5.00pm on the expiry of the cooling off period.

**41. Claim for Compensation**

Notwithstanding the provisions of clause 7 hereof, the parties agree that any claim for compensation shall be deemed to be an objection or requisition for the purposes of Clause 8 hereof.

**42. Purchaser to indemnify Vendor's Costs**

If Settlement of this matter doesn't occur on the scheduled day of completion due to default of the Purchaser, or his mortgagee, then the Purchaser shall pay all fees including but not limiting to agency fees, re-certification fees and Vendors Conveyancers fees, incurred by the Vendor, or his mortgagee, in relation to any re-arrangement of settlement. The Purchaser agrees that the Vendors Conveyancer fee for re-arrangement of settlement is \$220.00 inclusive of GST.

Should the purchaser request and the vendor accept an extension to the cooling off period the purchaser shall allow the sum of \$88.00 to the vendor for conveyancing costs related to facilitating the extension in writing at completion.

**Central Coast Conveyancing Firm**  
**Property ; 4/27 Brougham Street, East Gosford**  
**Vendor; Catherine Anne Low**

**43. Deposit**

Should a part payment of the 10% deposit be requested and it is deemed acceptable to the Vendor and/or their representative;

The parties acknowledge that the deposit is 10% of the purchase price and is an essential term of the contract & it may be paid in the following instalments:

- (a) The Initial part payment of deposit due & payable on exchange of Contracts being 5 % of the purchase price and;
- (b) The Balance of Deposit being 5 % of the purchase price on demand provided the Vendor shall not demand payment unless the purchaser is in breach of an essential term of this Contract.

If the Purchaser fails to pay the Balance Deposit to the Vendor pursuant to (b) above, the Vendor shall be entitled to sue the Purchaser for the Balance Deposit as a liquidated debt in addition to any other remedies available.

**44. Purchaser agrees and warrants**

1. The purchaser has not relied upon any warranty or representation made by the Vendor or any other person on the vendor's behalf unless expressly stated herein; and
2. The purchaser relies solely on its own enquires relating to the property including but not limited to any encroachments by or on the subject property and location of fencing and any possible irregularities in fencing.
3. The purchaser warrants that it does not require the consent of the Commonwealth Treasurer pursuant to the Foreign Acquisitions and takeover Act 1975 to carry out the purchase. In the event of there being a breach of this warranty whether deliberate or otherwise the purchaser agrees to indemnify and to compensate the Vendor in respect of any loss or damage that may be incurred by the vendor as a consequence of such breach.
4. The purchaser holds a current loan approval or does not require finance for completion.
5. The Purchaser acknowledges that this contract sets out all the terms, conditions and warranties in connection with this sale.

**45. Requisitions on Title**

The purchaser's general requisitions about the property or the title under Clause 5 shall be limited to the requisitions attached to this Contract.

**46. Guarantee & Indemnity if the Purchaser is a Company**

- (a) If the purchaser of the property is a Company, the Officers or persons who sign the Contract on behalf of the Company or who attest the Seal of the Company on this Contract:
  - (i) Jointly and separately guarantee all obligations of the purchaser under this Agreement including the payment of the purchase price;
  - (ii) Jointly and separately indemnify the vendor in respect of any default of the purchaser under this Agreement
- (b) This guarantee and indemnity is given by each guarantor as principal and is not discharged or released by any release or variation between the vendor and the purchaser of this Agreement

**Central Coast Conveyancing Firm**  
**Property ; 4/27 Brougham Street, East Gosford**  
**Vendor; Catherine Anne Low**

**47. Release of Deposit**

The parties agree that the deposit (or such part as shall be required by the Vendor) shall be released to the Vendor or the Vendor's Conveyancer on demand to enable payment of a deposit on an alternate purchase by the Vendor, provided:

- (a) any amount released shall be held by a licensed Real Estate Agent, Licensed Conveyancer or Solicitor until settlement;
- (b) the Vendor may require the amount on exchange of this Contract in accordance with the written direction by Vendor's Solicitor;
- (c) written authority by the purchaser's representative is not required to release the deposit; and this condition is an essential term of the Contract

**48.** The vendor and purchaser agree that if the vendor requires the deposit to be available on completion to discharge the vendor's liabilities under any mortgage or as settlement funds for a simultaneous purchase, the purchaser agrees to authorise the deposit holder to have the deposit available at settlement as requested by the vendors' representative provided that such deposit is returned to the deposit holder's trust account within 48 hours in the event that settlement is not effected as scheduled.

**49. COVID-19 Pandemic – Completion date**

This clause applies whilst ever the Federal, NSW State, or Local Government area in which the dwelling is situated, is managing the COVID-19 pandemic as a Health Emergency or a State Emergency:

- (a) In the event any party to the Contract is required to undertake self-isolation or quarantine, or needs to care for an immediate member of their household or family who is directly affected by self-isolation or quarantine, such party will notify the other party immediately AND in the event that completion cannot take place by the due date for completion, due to self-isolation or quarantine, then the completion date is extended by 21 days.
- (b) In the event any party is admitted to hospital as a consequence of COVID-19 Coronavirus, such party will notify the other party as soon as possible AND in the event that completion cannot take place by the due date, due to such hospitalisation, then the completion date is extended by 21 days from the date of the party's discharge from hospital.

**50. Purchaser accepts vendor electronically signed Contract**

If the Vendor elects to sign the Contract using docusign or by other electronic means, then the following provisions shall apply:

- a. The Purchaser and their legal representative agree to accept a docusign Vendor counterpart Contract for the purposes of exchange and settlement
- b. The Vendor and their legal representative have no obligation to provide an original wet signature counterpart Contract
- c. The Purchaser will not make any claim, rescind, terminate, or delay completion for any matter raised in this condition

## STRATA TITLE (RESIDENTIAL) PROPERTY REQUISITIONS ON TITLE

Vendor:  
Purchaser:  
Property:           Unit  
Dated:

---

### Possession and tenancies

1. Vacant possession of the Property must be given on completion unless the Contract provides otherwise.
2. Is anyone in adverse possession of the Property or any part of it?
3.
  - (a) What are the nature and provisions of any tenancy or occupancy?
  - (b) If they are in writing, all relevant documentation should be produced, found in order and handed over on completion with notices of attornment.
  - (c) Please specify any existing breaches.
  - (d) All rent should be paid up to or beyond the date of completion.
  - (e) Please provide details of any bond together with the Rental Bond Board's reference number.
  - (f) If any bond money is held by the Rental Bond Board, the appropriate transfer documentation duly signed should be handed over on completion.
4. Is the Property affected by a protected tenancy (tenancy affected by Parts 2, 3, 4 or 5 of the *Landlord and Tenant (Amendment) Act 1948 (NSW)*)? If so, please provide details.
5. If the tenancy is subject to the *Residential Tenancies Act 2010 (NSW)*:
  - (a) has either the vendor or any predecessor or the tenant applied to the NSW Civil and Administrative Tribunal for an order?
  - (b) have any orders been made by the NSW Civil and Administrative Tribunal? If so, please provide details.

### Title

6. Subject to the Contract, on completion the vendor should be registered as proprietor in fee simple of the Property free from all encumbrances and notations and recorded as the owner of the Property on the strata roll, free from all other interests.
7. On or before completion, any mortgage, caveat, writ or priority notice must be discharged, withdrawn, cancelled or removed as the case may be or, in the case of a mortgage, caveat or priority notice, an executed discharge or withdrawal or removal handed over on completion together with a notice under Section 22 of the *Strata Schemes Management Act 2015 (NSW) (Act)*.
8. Are there any proceedings pending or concluded that could result in the recording of any writ on the title to the Property or in the General Register of Deeds? If so, full details should be provided at least 14 days prior to completion.
9. When and where may the title documents be inspected?
10. Are any chattels or fixtures subject to any hiring or leasing agreement or charge or to any security interest under the *Personal Properties Securities Act 2009 (Cth)*? If so, details must be given and all indebtedness cleared and title transferred unencumbered to the vendor prior to completion.

### Adjustments

11. All outgoings referred to in clause 14.1 of the Contract must be paid up to and including the date of completion.
12. Is the vendor liable to pay land tax or is the Property otherwise charged or liable to be charged with land tax? If so:
  - (a) to what year has a return been made?
  - (b) what is the taxable value of the Property for land tax purposes for the current year?
13. The vendor must serve on the purchaser a current land tax certificate (issued under Section 47 of the *Land Tax Management Act 1956 (NSW)*) at least 14 days before completion.

### Survey and building

14. Subject to the Contract, survey should be satisfactory and show that the whole of the Property and the common property is available, that there are no encroachments by or upon the Property or the common property.
15. Is the vendor in possession of a survey report? If so, please produce a copy for inspection prior to completion. The original should be handed over on completion.
16. In respect of the Property and the common property:
  - (a) Have the provisions of the *Local Government Act (NSW)*, the *Environmental Planning and Assessment Act 1979 (NSW)* and their regulations been complied with?
  - (b) Is there any matter that could justify the making of an upgrading or demolition order in respect of any building or structure?



- (c) Has the vendor a Building Certificate which relates to all current buildings or structures on the Property? If so, it should be handed over on completion. Please provide a copy in advance.
  - (d) Has the vendor a Final Occupation Certificate issued under the *Environmental Planning and Assessment Act 1979* for all current buildings or structures on the Property? If so, it should be handed over on completion. Please provide a copy in advance.
  - (e) In respect of any residential building work carried out in the last 7 years:
    - (i) please identify the building work carried out;
    - (ii) when was the building work completed?
    - (iii) please state the builder's name and licence number;
    - (iv) please provide details of insurance under the *Home Building Act 1989 (NSW)*.
  - (f) Are there any proposals by the Owners Corporation or an owner of a lot to make any additions or alterations or to erect any new structures on the common property? If so, please provide details.
  - (g) Has any work been carried out by the vendor on the Property or the common property? If so:
    - (i) has the work been carried out in accordance with the by-laws and all necessary approvals and consents?
    - (ii) does the vendor have any continuing obligations in relation to the common property affected?
17. Is the vendor aware of any proposals to:
- (a) resume the whole or any part of the Property or the common property?
  - (b) carry out building alterations to an adjoining lot which may affect the boundary of that lot or the Property?
  - (c) deal with, acquire, transfer, lease or dedicate any of the common property?
  - (d) dispose of or otherwise deal with any lot vested in the Owners Corporation?
  - (e) create, vary or extinguish any easements, restrictions or positive covenants over the Property or the common property?
  - (f) subdivide or consolidate any lots and/or any common property or to convert any lots into common property?
  - (g) grant any licence to any person, entity or authority (including the Council) to use the whole or any part of the common property?
18. Has the vendor (or any predecessor) or the Owners Corporation entered into any agreement with or granted any indemnity to the Council or any other authority concerning any development on the Property or the common property?
19. In relation to any swimming pool on the Property or the common property:
- (a) did its installation or construction commence before or after 1 August 1990?
  - (b) has the swimming pool been installed or constructed in accordance with approvals under the *Local Government Act 1919 (NSW)* and *Local Government Act 1993 (NSW)*?
  - (c) does it comply with the provisions of the *Swimming Pools Act 1992 (NSW)* and regulations relating to access? If not, please provide details of the exemptions claimed;
  - (d) have any notices or orders issued or been threatened under the *Swimming Pools Act 1992 (NSW)* or regulations?
  - (e) if a certificate of non-compliance has issued, please provide reasons for its issue if not disclosed in the contract;
  - (f) originals of certificate of compliance or non-compliance and occupation certificate should be handed over on settlement.
- 20.
- (a) Is the vendor aware of any dispute regarding boundary or dividing fences in the strata scheme?
  - (b) Is the vendor aware of any notice, claim or proceedings under the *Dividing Fences Act 1991 (NSW)* or the *Encroachment of Buildings Act 1922 (NSW)* affecting the strata scheme?

**Affectations, notices and claims**

21. In respect of the Property and the common property:
- (a) Is the vendor aware of any rights, licences, easements, covenants or restrictions as to use of them other than those disclosed in the Contract?
  - (b) Has any claim been made by any person to close, obstruct or limit access to or from them or to prevent the enjoyment of any easement appurtenant to them?
  - (c) Is the vendor aware of:
    - (i) any road, drain, sewer or storm water channel which intersects or runs through them?
    - (ii) any dedication to or use by the public of any right of way or other easement over any part of them?
    - (iii) any latent defects in them?
  - (d) Has the vendor any notice or knowledge of them being affected by the following:
    - (i) any notice requiring work to be done or money to be spent on them or any footpath or road adjoining? If so, such notice must be complied with prior to completion.
    - (ii) any work done or intended to be done on them or the adjacent street which may create a charge on them or the cost of which might be or become recoverable from the purchaser?
    - (iii) any sum due to any local or public authority recoverable from the purchaser? If so, it must be paid prior to completion.
    - (iv) any realignment or proposed realignment of any road adjoining them?

- (v) any contamination including, but not limited to, materials or substances dangerous to health such as asbestos and fibreglass?

**Applications, Orders etc**

22. Are there any applications made, proposed or threatened, whether by an owner of a lot or the Owners Corporation, to the NSW Civil and Administrative Tribunal, any Court or to the Registrar General for orders relating to the strata scheme, the Property or the common property (including orders to vary the strata scheme consequent upon damage or destruction or to terminate the strata scheme) which are yet to be determined? If so, please provide particulars.
23. Are there any mediations currently being conducted by the Commissioner of Fair Trading, Department of Finance Services and Innovation in relation to the Property or the common property which involve the vendor or the Owners Corporation? If so, please provide particulars.
24. Are there any:
- (a) orders of the Tribunal;
  - (b) notices of or investigations by the Owners Corporation;
  - (c) notices or orders issued by any Court; or
  - (d) notices or orders issued by the Council or any public authority or water authority,
- affecting the Property or the common property not yet complied with? In so far as they impose an obligation on the vendor they should be complied with by the vendor before completion.
25. Have any orders been made by any Court or Tribunal that money (including costs) payable by the Owners Corporation be paid from contributions levied in relation to the Property? If so, please provide particulars.
26. Has the vendor made any complaints or been the subject of any complaints arising out of noise affecting the Property or emanating from the Property?
27. Has any proposal been given by any person or entity to the Owners Corporation for:
- (a) a collective sale of the strata scheme; or
  - (b) a redevelopment of the strata scheme?
- If so, please provide particulars of the proposal and the steps taken and decisions made in relation to the proposal to the present time.

**Owners Corporation management**

28. Has the initial period expired?
29. Are any actions proposed to be taken or have any been taken by the Owners Corporation in the initial period which would be in breach of its powers without an order authorising them?
30. If the Property includes a utility lot, please specify the restrictions.
31. Do any special expenses (as defined in clause 23.2 of the Contract, including any liabilities of the Owners Corporation) exceed 1% of the price?
32. Has an appointment of a strata managing agent and/or a building manager been made? If so:
- (a) who has been appointed to each role;
  - (b) when does the term of each appointment expire; and
  - (c) what functions have been delegated to the strata managing agent and/or the building manager.
33. Has the Owners Corporation entered into any agreement to provide amenities or services to the Property? If so, please provide particulars.
34. Has a resolution been passed for the distribution of surplus money from the administrative fund or the capital works fund? If so, please provide particulars.
35. Have the by-laws adopted a common property memorandum as prescribed by the regulations for the purposes of Section 107 of the Act? If so, has the memorandum been modified? Please provide particulars.
36. Is there a registered building management statement pursuant to Section 108 of the *Strata Schemes Development Act 2015 (NSW)*? If so, are there any proposals to amend the registered building management statement?
37. If the strata scheme was in existence at 30 November 2016, has the Owners Corporation taken steps to review the by-laws that were current at that date? If so, please provide particulars.
38. Are there any pending proposals to amend or repeal the current by-laws or to add to them?
39. Are there any proposals, policies or by-laws in relation to the conferral of common property rights or which deal with short term licences and/or holiday lettings?
40. If not attached to the Contract, a strata information certificate under Section 184 of the Act should be served on the purchaser at least 7 days prior to completion.
41. Has the Owners Corporation met all of its obligations under the Act relating to:
- (a) insurances;
  - (b) fire safety;
  - (c) occupational health and safety;
  - (d) building defects and rectification in relation to any applicable warranties under the *Home Building Act 1989 (NSW)*;
  - (e) the preparation and review of the 10 year plan for the capital works fund; and
  - (f) repair and maintenance.
42. Is the secretary of the Owners Corporation in receipt of a building bond for any building work on a building that is part of the Property or the common property?
43. Has an internal dispute resolution process been established? If so, what are its terms?
44. Has the Owners Corporation complied with its obligation to lodge tax returns with the Australian Taxation Office and has all tax liability been paid?

- Capacity**
45. If the Contract discloses that the vendor is a trustee, evidence should be produced to establish the trustee's power of sale.

- Requisitions and transfer**
46. If not attached to the Contract and the transaction is not an excluded transaction, any *clearance certificate* under Section 14-220 of Schedule 1 of the *Taxation Administration Act 1953 (Cth)* should be served on the purchaser at least 7 days prior to completion.
47. If the transfer or any other document to be handed over on completion is executed pursuant to a power of attorney, then at least 7 days prior to completion a copy of the registered power of attorney should be produced and found in order.
48. If the vendor has or is entitled to have possession of the title deeds the Certificate Authentication Code must be provided 7 days prior to settlement.
49. Searches, surveys, enquiries and inspection of title deeds must prove satisfactory.
50. The purchaser reserves the right to make further requisitions prior to completion.
51. Unless we are advised by you to the contrary prior to completion, it will be assumed that your replies to these requisitions remain unchanged as at the completion date.



FOLIO: 4/SP30311

-----

SEARCH DATE	TIME	EDITION NO	DATE
-----	----	-----	----
4/6/2021	10:19 AM	11	13/12/2019

LAND

-----

LOT 4 IN STRATA PLAN 30311  
AT EAST GOSFORD  
LOCAL GOVERNMENT AREA CENTRAL COAST

FIRST SCHEDULE

-----

CATHERINE ANNE LOW (T AP767677)

SECOND SCHEDULE (1 NOTIFICATION)

-----

1 INTERESTS RECORDED ON REGISTER FOLIO CP/SP30311

NOTATIONS

-----

UNREGISTERED DEALINGS: NIL

\*\*\* END OF SEARCH \*\*\*



FOLIO: CP/SP30311

-----

SEARCH DATE	TIME	EDITION NO	DATE
4/6/2021	10:19 AM	3	1/12/2017

LAND

-----

THE COMMON PROPERTY IN THE STRATA SCHEME BASED ON STRATA PLAN 30311  
WITHIN THE PARCEL SHOWN IN THE TITLE DIAGRAM

AT EAST GOSFORD  
LOCAL GOVERNMENT AREA CENTRAL COAST  
PARISH OF GOSFORD COUNTY OF NORTHUMBERLAND  
TITLE DIAGRAM SHEET 1 SP30311

FIRST SCHEDULE

-----

THE OWNERS - STRATA PLAN NO. 30311  
ADDRESS FOR SERVICE OF DOCUMENTS:  
C/- BCS STRATA MANAGEMENT PTY LTD  
LOCKED BAG 22  
HAYMARKET NSW 1238

SECOND SCHEDULE (2 NOTIFICATIONS)

-----

- 1 RESERVATIONS AND CONDITIONS IN THE CROWN GRANT(S)
- 2 ATTENTION IS DIRECTED TO BY-LAWS SET OUT IN SCHEDULE 2 STRATA  
SCHEMES MANAGEMENT REGULATION 2016

SCHEDULE OF UNIT ENTITLEMENT (AGGREGATE: 4)

-----

STRATA PLAN 30311

LOT	ENT	LOT	ENT	LOT	ENT	LOT	ENT
1	- 1	2	- 1	3	- 1	4	- 1

NOTATIONS

-----

UNREGISTERED DEALINGS: NIL

\*\*\* END OF SEARCH \*\*\*

Low

PRINTED ON 4/6/2021

\* Any entries preceded by an asterisk do not appear on the current edition of the Certificate of Title. Warning: the information appearing under notations has not been formally recorded in the Register. InfoTrack an approved NSW Information Broker hereby certifies that the information contained in this document has been provided electronically by the Registrar General in accordance with Section 96B(2) of the Real Property Act 1900.

FORM 1

COINCIDENTS CERTIFICATE

The Details of the 1994-1995 Financial Year of **WESTPAC BANKING CORPORATION** having been audited and approved by the Auditor-General of New South Wales in accordance with the provisions of the Companies Act 1993 and the provisions of the Financial Reporting Act 1995 are as follows:

Company Name: **WESTPAC BANKING CORPORATION**  
 Date: **4-10-85**  
 Auditor: **Arthur Andersen & Co.**  
 Registered Office: **Westpac Banking Corporation, 100 Market Street, Sydney, New South Wales 2000.**

Signatures, seals and statements of intention to create easements or restrictions as to user.

This is sheet 1 of my Plan in 2 sheets.

WARNING: CREASING OR FOLDING WILL LEAD TO REJECTION

OFFICE USE ONLY

**SUBJECT'S CERTIFICATE**  
**MICHAEL DOONING DOONING**  
**194 CHILDER AVENUE, STAINBROOK**  
 The details of the 1994-1995 Financial Year of the above-named company are as follows:

Company Name: **MICHAEL DOONING DOONING**  
 Date: **2-8-85**  
 Auditor: **McKewen & Co.**  
 Registered Office: **194 Childer Avenue, Stainbrook, New South Wales 2150.**

**WESTPAC BANKING CORPORATION**  
 by its Attorney

who hereby states that at the time of executing this instrument no notice of revocation has been received of the Power of Attorney registered in the office of the Registrar General No. **134** Book **2598** under the authority of which this instrument has been executed.

*[Signature]*  
**PERSONAL SECURITIES**  
**HURSTVILLE**

Signed Stated and Delivered for and on behalf of **WESTPAC BANKING CORPORATION**  
**ALAN HYDE**  
 by its duly constituted Attorney who is personally known to me  
*[Signature]*  
**CORRAINE WOODS**  
**BANK OFFICER**  
**SUTHERLAND**

*[Signature]*  
**REGISTRAR**  
*[Signature]*  
**SECRETARY**

**PRECISE CONSTRUCTIONS PTY. LTD.**  
 (Seal)

M.P.D. 10 20 30 40 50 60 70 80 90 100 110 120 130 140 150

SUBJECT'S REFERENCE: 851548

**PLAN OF SUBDIVISION OF LOT 31, D.P. 614/89**

Address: **GOSFORD** Locality: **EAST GOSFORD**

Parish: **GOSFORD** County: **NORTHUMBERLAND**

Reduction Ratio: **1: 300** Lengths are in metres 

Name of, and address for service of notices on, the body corporate:  
**THE PROPRIETORS - STRATA PLAN No 30311**  
**27 BROUGHAM STREET**  
**EAST GOSFORD, 2250.**

**STRATA PLAN 30311**

Registered:  **PC 26-11-1985**

C.A. No: **1104 OF 4-10-1985**

Purpose: **STRATA PLAN**

Ref. Map: **U2797-842**

Last Plan: **D.P. 614/89**

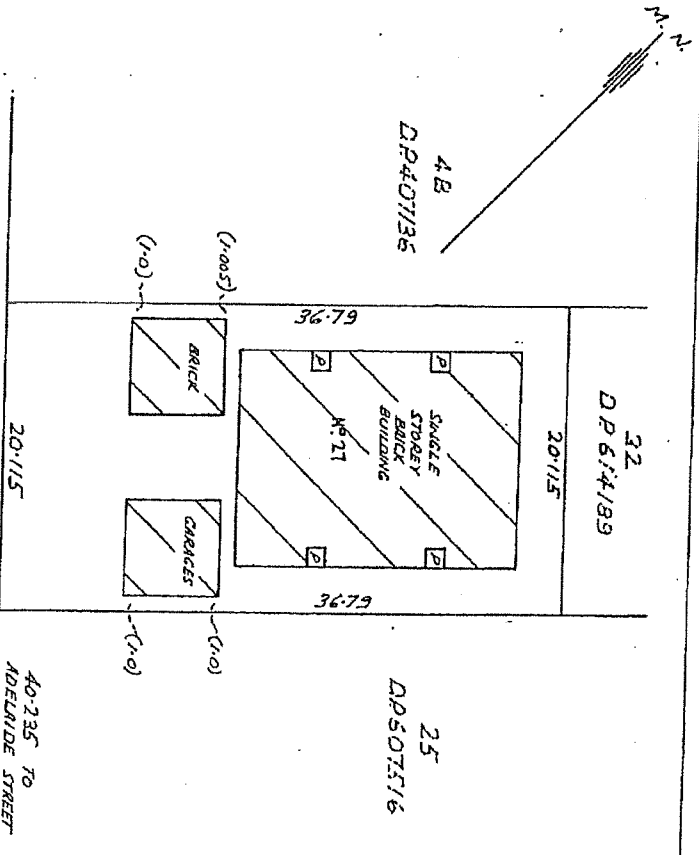

Plan Drawing only to appear in this space

2	2	0	0	0	0
---	---	---	---	---	---

WARNING: CREASING OR FOLDING WILL LEAD TO REJECTION

Sheet No. 2 of 2 Sheets

STRATA PLAN 70311

GROUND FLOOR

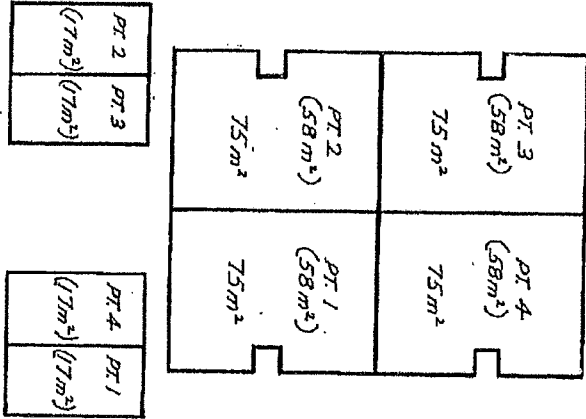

AREAS ARE APPROXIMATE ONLY

SCHEDULE OF UNIT ENTITLEMENT	
LOT N°	UNIT ENTITLEMENT
1	1
2	1
3	1
4	1
AGGREGATE	4

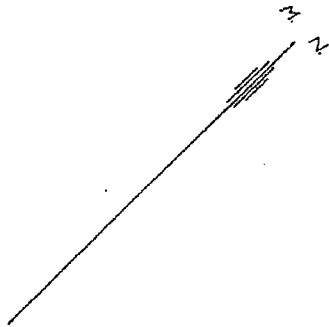

Reduction Ratio 1: 200

Lengths are in metres

*M. Downing*  
 Registered Surveyor

*[Signature]*  
 Strata Management Clerk



# Strata Schemes Management Regulation 2016

Current version for 18 December 2017 to date (accessed 10 January 2020 at 09:55)

Schedule 2

## Schedule 2 By-laws for pre-1996 strata schemes

(Clause 35)

### 1 Noise

An owner or occupier of a lot must not create any noise on the parcel likely to interfere with the peaceful enjoyment of the owner or occupier of another lot or of any person lawfully using common property.

**Note.** This by-law was previously by-law 12 in Schedule 1 to the *Strata Schemes (Freehold Development) Act 1973* and by-law 13 in Schedule 3 to the *Strata Schemes (Leasehold Development) Act 1986*.

### 2 Vehicles

An owner or occupier of a lot must not park or stand any motor or other vehicle on common property except with the written approval of the owners corporation.

**Note.** This by-law was previously by-law 13 in Schedule 1 to the *Strata Schemes (Freehold Development) Act 1973* and by-law 14 in Schedule 3 to the *Strata Schemes (Leasehold Development) Act 1986*.

### 3 Obstruction of common property

An owner or occupier of a lot must not obstruct lawful use of common property by any person.

**Note.** This by-law was previously by-law 14 in Schedule 1 to the *Strata Schemes (Freehold Development) Act 1973* and by-law 15 in Schedule 3 to the *Strata Schemes (Leasehold Development) Act 1986*.

### 4 Damage to lawns and plants on common property

An owner or occupier of a lot must not:

- (a) damage any lawn, garden, tree, shrub, plant or flower being part of or situated on common property, or
- (b) use for his or her own purposes as a garden any portion of the common property.

**Note.** This by-law was previously by-law 15 in Schedule 1 to the *Strata Schemes (Freehold Development) Act 1973* and by-law 16 in Schedule 3 to the *Strata Schemes (Leasehold Development) Act 1986*.

### 5 Damage to common property

- (1) An owner or occupier of a lot must not mark, paint, drive nails or screws or the like into, or otherwise damage or deface, any structure that forms part of the common property without the approval in writing of the owners corporation.

**Note.** This by-law is subject to sections 109 and 110 of the *Strata Schemes Management Act 2015*.

- (2) An approval given by the owners corporation under clause (1) cannot authorise any additions to the common property.
- (3) This by-law does not prevent an owner or person authorised by an owner from installing:
  - (a) any locking or other safety device for protection of the owner's lot against intruders, or



- (b) any screen or other device to prevent entry of animals or insects on the lot, or
  - (c) any structure or device to prevent harm to children.
- (4) Any such locking or safety device, screen, other device or structure must be installed in a competent and proper manner and must have an appearance, after it has been installed, in keeping with the appearance of the rest of the building.
- (5) Despite section 106 of the *Strata Schemes Management Act 2015*, the owner of a lot must maintain and keep in a state of good and serviceable repair any installation or structure referred to in clause (3) that forms part of the common property and that services the lot.

**Note.** This by-law was previously by-law 16 in Schedule 1 to the *Strata Schemes (Freehold Development) Act 1973* and by-law 17 in Schedule 3 to the *Strata Schemes (Leasehold Development) Act 1986*.

## **6 Behaviour of owners and occupiers**

An owner or occupier of a lot when on common property must be adequately clothed and must not use language or behave in a manner likely to cause offence or embarrassment to the owner or occupier of another lot or to any person lawfully using common property.

**Note.** This by-law was previously by-law 17 in Schedule 1 to the *Strata Schemes (Freehold Development) Act 1973* and by-law 18 in Schedule 3 to the *Strata Schemes (Leasehold Development) Act 1986*.

## **7 Children playing on common property in building**

An owner or occupier of a lot must not permit any child of whom the owner or occupier has control to play on common property within the building or, unless accompanied by an adult exercising effective control, to be or to remain on common property comprising a laundry, car parking area or other area of possible danger or hazard to children.

**Note.** This by-law was previously by-law 18 in Schedule 1 to the *Strata Schemes (Freehold Development) Act 1973* and by-law 19 in Schedule 3 to the *Strata Schemes (Leasehold Development) Act 1986*.

## **8 Behaviour of invitees**

An owner or occupier of a lot must take all reasonable steps to ensure that invitees of the owner or occupier do not behave in a manner likely to interfere with the peaceful enjoyment of the owner or occupier of another lot or any person lawfully using common property.

**Note.** This by-law was previously by-law 19 in Schedule 1 to the *Strata Schemes (Freehold Development) Act 1973* and by-law 20 in Schedule 3 to the *Strata Schemes (Leasehold Development) Act 1986*.

## **9 Depositing rubbish and other material on common property**

An owner or occupier of a lot must not deposit or throw on the common property any rubbish, dirt, dust or other material likely to interfere with the peaceful enjoyment of the owner or occupier of another lot or of any person lawfully using the common property.

**Note.** This by-law was previously by-law 20 in Schedule 1 to the *Strata Schemes (Freehold Development) Act 1973* and by-law 21 in Schedule 3 to the *Strata Schemes (Leasehold Development) Act 1986*.

## **10 Drying of laundry items**

An owner or occupier of a lot must not, except with the consent in writing of the owners corporation, hang any washing, towel, bedding, clothing or other article on any part of the parcel in such a way as to be visible from outside the building other than on any lines provided by the owners corporation for the purpose and there only for a reasonable period.

**Note.** This by-law was previously by-law 21 in Schedule 1 to the *Strata Schemes (Freehold Development) Act 1973* and by-law 22 in Schedule 3 to the *Strata Schemes (Leasehold Development) Act 1986*.

## 11 Cleaning windows and doors

An owner or occupier of a lot must keep clean all glass in windows and all doors on the boundary of the lot, including so much as is common property.

**Note.** This by-law was previously by-law 22 in Schedule 1 to the *Strata Schemes (Freehold Development) Act 1973* and by-law 23 in Schedule 3 to the *Strata Schemes (Leasehold Development) Act 1986*.

## 12 Storage of inflammable liquids and other substances and materials

- (1) An owner or occupier of a lot must not, except with the approval in writing of the owners corporation, use or store on the lot or on the common property any inflammable chemical, liquid or gas or other inflammable material.
- (2) This by-law does not apply to chemicals, liquids, gases or other material used or intended to be used for domestic purposes, or any chemical, liquid, gas or other material in a fuel tank of a motor vehicle or internal combustion engine.

**Note.** This by-law was previously by-law 23 in Schedule 1 to the *Strata Schemes (Freehold Development) Act 1973* and by-law 24 in Schedule 3 to the *Strata Schemes (Leasehold Development) Act 1986*.

## 13 Moving furniture and other objects on or through common property

An owner or occupier of a lot must not transport any furniture or large object through or on common property within the building unless sufficient notice has first been given to the strata committee so as to enable the strata committee to arrange for its nominee to be present at the time when the owner or occupier does so.

**Note.** This by-law was previously by-law 24 in Schedule 1 to the *Strata Schemes (Freehold Development) Act 1973* and by-law 25 in Schedule 3 to the *Strata Schemes (Leasehold Development) Act 1986*.

## 14 Floor coverings

- (1) An owner of a lot must ensure that all floor space within the lot is covered or otherwise treated to an extent sufficient to prevent the transmission from the floor space of noise likely to disturb the peaceful enjoyment of the owner or occupier of another lot.
- (2) This by-law does not apply to floor space comprising a kitchen, laundry, lavatory or bathroom.

**Note.** This by-law was previously by-law 25 in Schedule 1 to the *Strata Schemes (Freehold Development) Act 1973* and by-law 26 in Schedule 3 to the *Strata Schemes (Leasehold Development) Act 1986*.

## 15 Garbage disposal

An owner or occupier of a lot:

- (a) must maintain within the lot, or on such part of the common property as may be authorised by the owners corporation, in clean and dry condition and adequately covered a receptacle for garbage, and
- (b) must ensure that before refuse is placed in the receptacle it is securely wrapped or, in the case of tins or other containers, completely drained, and
- (c) for the purpose of having the garbage collected, must place the receptacle within an area designated for that purpose by the owners corporation and at a time not more than 12 hours before the time at which garbage is normally collected, and
- (d) when the garbage has been collected, must promptly return the receptacle to the lot or other area referred to in paragraph (a), and
- (e) must not place any thing in the receptacle of the owner or occupier of any other lot except with the permission of that owner or occupier, and

- (f) must promptly remove any thing which the owner, occupier or garbage collector may have spilled from the receptacle and must take such action as may be necessary to clean the area within which that thing was spilled.

**Note.** This by-law was previously by-law 26 in Schedule 1 to the *Strata Schemes (Freehold Development) Act 1973* and by-law 27 in Schedule 3 to the *Strata Schemes (Leasehold Development) Act 1986*.

## **16 Keeping of animals**

- (1) Subject to section 157 of the *Strata Schemes Management Act 2015*, an owner or occupier of a lot must not, without the approval in writing of the owners corporation, keep any animal on the lot or the common property.
- (2) The owners corporation must not unreasonably withhold its approval of the keeping of an animal on a lot or the common property.

**Note.** This by-law was previously by-law 27 in Schedule 1 to the *Strata Schemes (Freehold Development) Act 1973* and by-law 28 in Schedule 3 to the *Strata Schemes (Leasehold Development) Act 1986*.

## **17 Appearance of lot**

- (1) The owner or occupier of a lot must not, without the written consent of the owners corporation, maintain within the lot anything visible from outside the lot that, viewed from outside the lot, is not in keeping with the rest of the building.
- (2) This by-law does not apply to the hanging of any washing, towel, bedding, clothing or other article as referred to in by-law 10.

**Note.** This by-law was previously by-law 29 in Schedule 1 to the *Strata Schemes (Freehold Development) Act 1973* and by-law 30 in Schedule 3 to the *Strata Schemes (Leasehold Development) Act 1986*.

## **18 Notice board**

An owners corporation must cause a notice board to be affixed to some part of the common property.

**Note.** This by-law was previously by-law 3 in Schedule 1 to the *Strata Schemes (Freehold Development) Act 1973* and by-law 3 in Schedule 3 to the *Strata Schemes (Leasehold Development) Act 1986*.

## **19 Change in use of lot to be notified**

An occupier of a lot must notify the owners corporation if the occupier changes the existing use of the lot in a way that may affect the insurance premiums for the strata scheme (for example, if the change of use results in a hazardous activity being carried out on the lot, or results in the lot being used for commercial or industrial purposes rather than residential purposes).



Central Coast Conveyancing Firm  
felicity@cccfirm.com.au

## PLANNING CERTIFICATE

This Planning Certificate is issued in accordance with Section 10.7 (2) of the *Environmental Planning and Assessment Act, 1979*

Certificate No: 172985  
Certificate Date: 8 June 2021  
Address: 4/27 Brougham Street EAST GOSFORD  
Lot Description: LOT: 4 SP: 30311

This certificate is issued on the Strata Plan including preceding or subsequent lots in an earlier or later strata plan. Any purchaser or owner of a lot in a strata plan needs to know about the planning restrictions of the land as they buy or own a share in the management of that land through the owners corporation.

Parish: Gosford  
County: Northumberland  
Assessment No: 96275  
Receipt No:  
Parcel No: 61167  
Applicants Reference: Low  
Applicants Email:



Wyong Office: 2 Hely St / PO Box 20 Wyong NSW 2259  
Gosford Office: 49 Mann St / PO Box 21 Gosford NSW 2250  
P 1300 463 954 | E [ask@centralcoast.nsw.gov.au](mailto:ask@centralcoast.nsw.gov.au) | W [centralcoast.nsw.gov.au](http://centralcoast.nsw.gov.au) | ABN 73 149 644 003

**This Certificate contains information specified in Schedule 4 of the Environmental  
Planning and Assessment Regulation 2000**

**1 NAMES OF RELEVANT PLANNING INSTRUMENTS and DCPS**

- (1) The name of each environmental planning instrument that applies to the carrying out of development on the land.

Gosford Local Environmental Plan 2014

***Specific Site State Environmental Planning Policies***

State Environmental Planning Policy (Coastal Management) 2018 (whole of lot).

State Environmental Planning Policy (Vegetation in Non-Rural Areas) 2017

***General Site State Environmental Planning Policies***

ZONE R1 GENERAL RESIDENTIAL UNDER GOSFORD LOCAL ENVIRONMENTAL PLAN 2014

State Environmental Planning Policy (State and Regional Development) 2011

State Environmental Planning Policy (Affordable Rental Housing) 2009

State Environmental Planning Policy (Exempt and Complying Development Codes) 2008

State Environmental Planning Policy (Infrastructure) 2007

State Environmental Planning Policy (Miscellaneous Consent Provisions) 2007

State Environmental Planning Policy (Mining, Petroleum Production and Extractive Industries) 2007

State Environmental Planning Policy (Major Development) 2005

State Environmental Planning Policy (Building Sustainability Index: BASIX) 2004

State Environmental Planning Policy (Housing for Seniors or People with a Disability) 2004

State Environmental Planning Policy No. 65 - Design Quality of Residential Apartment Development

State Environmental Planning Policy No. 64 - Advertising and Signage

State Environmental Planning Policy No. 55 - Remediation of Land

State Environmental Planning Policy No. 50 - Canal Estate Development

State Environmental Planning Policy No. 36 - Manufactured Home Estates

State Environmental Planning Policy No. 33 - Hazardous and Offensive Development

State Environmental Planning Policy No. 21 - Caravan Parks

State Environmental Planning Policy No. 19 - Bushland in Urban Areas

State Regional Planning Policy No. 9 - Extractive Industry (No 2-1995)

State Environmental Planning Policy (Educational Establishments and Child Care Facilities) 2017

State Environmental Planning Policy (Primary Production and Rural Development) 2019

State Environmental Planning Policy No 70 - Affordable Housing (Revised Schemes)  
State Environmental Planning Policy (Koala Habitat Protection) 2020.

- (2) The name of each proposed environmental planning instrument that will apply to the carrying out of development on the land and that is or has been the subject of community consultation or on public exhibition under the Act (unless the Director-General has notified the council that the making of the proposed instrument has been deferred indefinitely or has not been approved).

Draft Central Coast Local Environmental Plan will replace Gosford Local Environmental Plan 2014, Interim Development Order No. 122 - Gosford, Gosford Planning Scheme Ordinance and Wyong Local Environmental Plan 2013.

Draft State Environmental Planning Policy (Exempt and Complying Development Codes) 2008.

Draft State Environmental Planning Policy (Environment) 2017.

Draft State Environmental Planning Policy (Short-term Rental Accommodation) 2019

- (3) The name of each development control plan that applies to the carrying out of development on the land.

Gosford Development Control Plan 2013

## **2 ZONING AND LAND USE UNDER RELEVANT LOCAL ENVIRONMENTAL PLANS**

(a) to (d) is the zoning of the land and the land use table for each of the zones listed, including existing and proposed Local Environmental Plans in landuse tables.

Zone R1 General Residential under Gosford Local Environmental Plan 2014

PERMITTED WITHOUT CONSENT

Home occupations; Recreation areas

PERMITTED WITH CONSENT

Attached dwellings; Bed and breakfast accommodation; Boarding houses; Car parks; Centre-based child care facilities; Community facilities; Dual occupancies; Dwelling houses; Group homes; Home-based child care; Hostels; Hotel or motel accommodation; Multi dwelling housing; Neighbourhood shops; Oyster aquaculture; Places of public worship; Pond-base aquaculture; Residential flat buildings; Respite day care centres; Roads; Semi-detached dwellings; Seniors housing; Shop top housing; Tank-base aquaculture

PROHIBITED

Any development not specified in Permitted without consent or Permitted with consent

Proposed Zone R1 General Residential under Draft Central Coast Local Environmental Plan.

Please refer to attached Draft Land Use Table - R1 General Residential.

- (e) whether any development standards applying to the land fix minimum land dimensions for the erection of a dwelling-house on the land, if so, the minimum land dimensions so fixed,

No.

There are no development standards applying to the land that fix minimum land dimensions for the erection of a dwelling-house on the land. However there are minimum lot sizes applying to the subdivision of land, and in some zones the entitlement to erect a dwelling-house, or carry out other types of residential development, is linked to that minimum lot size.

- (f) whether the land includes or comprises critical habitat,

None

- (g) whether the land is in a conservation area (however described),

No.

- (h) whether an item of environmental heritage (however described) is situated on the land.

No.

## **2A ZONING AND LAND USE UNDER SEPP (SYDNEY REGIONAL GROWTH CENTRES) 2006**

Not applicable

## **3 COMPLYING DEVELOPMENT**

### **General Housing Code**

Complying development under the General Housing Code may be carried out on the land under Clauses 1.17A & 1.19. This information needs to be read in conjunction with the whole of the SEPP.

### **Rural Housing Code**

Complying development under the Rural Housing Code may be carried out on the land under Clauses 1.17A & 1.19. This information needs to be read in conjunction with the whole of the SEPP.

### **Housing Alterations Code**

Complying development under the Housing Alterations Code may be carried out on the land under Clauses 1.17A & 1.19. This information needs to be read in conjunction with the whole of the SEPP.

### **General Development Code**

Complying development under the General Development Code may be carried out on the land under Clauses 1.17A & 1.19. This information needs to be read in conjunction with the whole of the SEPP.

### **Subdivision Code**

Complying development under the Subdivision Code may be carried out on the land under Clauses 1.17A & 1.19. This information needs to be read in conjunction with the whole of the SEPP.

### **Demolition Code**

Complying development under the Demolition Code may be carried out on the land under Clauses 1.17A & 1.19. This information needs to be read in conjunction with the whole of the SEPP.

### **Commercial and Industrial (New Buildings and Additions) Code**

Complying development under the Commercial and Industrial (New Buildings and Additions) Code may be carried out on the land under Clauses 1.17A & 1.19. This information needs to be read in conjunction with the whole of the SEPP.

### **Commercial and Industrial Alterations Code**

Complying development under the Commercial and Industrial Alterations Code may be carried out on the land under Clauses 1.17A & 1.19. This information needs to be read in conjunction with the whole of the SEPP.

### **Fire Safety Code**

Complying development under the Fire Safety Code may be carried out on the land under Clauses 1.17A & 1.19. This information needs to be read in conjunction with the whole of the SEPP.

### **Low Rise Housing Diversity Code**

Complying development under the Low Rise Housing Diversity Code may be carried out on the land under Clauses 1.17A & 1.19. This information needs to be read in conjunction with the whole of the SEPP.

### **Greenfield Housing Code**

The Greenfield Housing Code is not applicable to this land.



**4 (Repealed)**

**4A (Repealed)**

**4B Annual Charges for coastal protection services under *Local Government Act 1993***

None

**5 MINE SUBSIDENCE**

This land has not been proclaimed to be a mine subsidence district within the meaning of section 15 of The Mine Subsidence Compensation Act, 1961.

**6 ROAD WIDENING AND ROAD RE-ALIGNMENT**

Whether or not the land is affected by any road widening or road alignment.

The land is not affected by Road Widening Proposals.

**7 COUNCIL AND OTHER PUBLIC AUTHORITY POLICIES ON HAZARD RISK RESTRICTIONS  
(No, unless a message is listed below)**

Chapter 6.4 of Gosford Development Control Plan (Geotechnical Requirements) applies to the land and the land may be subject to slip. When considering a development application, each circumstance will be considered and development may be restricted.

**7A FLOOD RELATED DEVELOPMENT CONTROLS INFORMATION**

Is development on the land or part of the land for the purposes of dwelling houses, dual occupancies, multi dwelling house or residential flat buildings (excluding group homes or seniors housing) subject to flood related development controls.

No.

Is development on the land or part of the land for any other purpose subject to flood related development controls.

No.

**8 LAND RESERVED FOR ACQUISITION**

No.

**9 CONTRIBUTION PLANS**

Contributions Plan No. 43A - East Gosford Local Open Space and No. 43B - East Gosford Local Roadworks

Contributions Plan No. 164 - Gosford Regional Centre

Central Coast Regional Section 7.12 Development Contributions Plan 2019.

**9A BIODIVERSITY CERTIFIED LAND**

Is the land biodiversity certified land under Part 8 of the *Biodiversity Conservation Act 2016*?

No.

**10 BIODIVERSITY STEWARDSHIP SITES**

Is the land a biodiversity stewardship site under a biodiversity stewardship agreement under Part 5 of the *Biodiversity Conservation Act 2016*?

No.

**10A NATIVE VEGETATION CLEARING SET ASIDES**

If the land contains a set aside area under section 60ZC of the *Local Land Services Act 2013*, a statement to that effect (but only if the council has been notified of the existence of the set aside area by Local Land Services or it is registered in the public register under that section).

None.

**11 BUSHFIRE PRONE LAND**

The land is not shown as bush fire prone on Council's records.

**12 PROPERTY VEGETATION PLANS**

Has Council been notified by the person or body that approved the plan that the land is land to which a property vegetation plan under the *Native Vegetation Act 2003* applies?

No.

**13 ORDERS UNDER TREES (DISPUTE BETWEEN NEIGHBOURS) ACT 2006**

Has Council been notified that an order has been made under the *Trees (Disputes Between Neighbours) Act 2006* to carry out work in relation to a tree on the land?

No.

**14 DIRECTIONS UNDER PART 3A**

If there is a direction by the Minister in force under section 75P (2) (c1) of the Act that a provision of an environmental planning instrument prohibiting or restricting the carrying out of a project or a stage of a project on the land under Part 4 of the Act does not have effect, a statement to that effect identifying the provision that does not have effect.

No.

**15 SITE COMPATIBILITY CERTIFICATES AND CONDITIONS FOR SENIORS HOUSING**

**15(a) IS COUNCIL AWARE OF A CURRENT SITE COMPATIBILITY CERTIFICATE (SENIORS HOUSING) IN RESPECT OF PROPOSED DEVELOPMENT ON THE LAND?**

If the land is land to which *State Environmental Planning Policy (Housing for Seniors or People with a Disability) 2004* applies.

No.

**15(b) ARE THERE ANY CONDITIONS IMPOSED BY A CONSENT AUTHORITY IN TERMS OF CLAUSE 18 (2) OF STATE ENVIRONMENTAL PLANNING POLICY (HOUSING FOR SENIORS OR PEOPLE WITH A DISABILITY) 2004 AFTER 11 OCTOBER 2007?**

No.

**16 SITE COMPATIBILITY CERTIFICATES FOR INFRASTRUCTURE**

No.

**17 SITE COMPATIBILITY CERTIFICATES AND CONDITIONS FOR AFFORDABLE RENTAL HOUSING**

**17(1) IS COUNCIL AWARE OF A CURRENT SITE COMPATIBILITY CERTIFICATE (AFFORDABLE RENTAL HOUSING) IN RESPECT OF PROPOSED DEVELOPMENT ON THE LAND?**

No.

**17(2) ARE THERE ANY CONDITIONS IMPOSED BY A CONSENT AUTHORITY IN TERMS OF CL 17 (1) OR 37 (1) OF STATE ENVIRONMENTAL PLANNING POLICY (AFFORDABLE RENTAL HOUSING) 2009?**

No.

## 18 PAPER SUBDIVISION INFORMATION

- (1) The name of any development plan adopted by a relevant authority that applies to the land or that is proposed to be subject to a consent ballot.

None

- (2) The date of any subdivision order that applies to the land.

Nil

## 19 SITE VERIFICATION CERTIFICATE

There is no current site verification certificate, of which the Council is aware in respect of the land.

## 20 LOOSE-FILL ASBESTOS INSULATION

NSW Fair Trading has not identified any residential dwellings erected within Central Coast Council Local Government Area as containing loose-fill asbestos ceiling insulation, as per the Loose-Fill Asbestos Insulation Register.

## 21 AFFECTED BUILDING NOTICES AND BUILDING PRODUCT RECTIFICATION ORDERS (BUILDING PRODUCT SAFETY ACT 2017)

- (1) Is there any affected building notice of which the council is aware that is in force in respect of the land?

No

- (2) Is there any building product rectification order of which the council is aware that is in force in respect of the land and has not been fully complied with?

No

- (3) Is there any notice of intention to make a building product rectification order of which the council is aware has been given in respect of the land and is outstanding.

No

## Note

### 1 **CONTAMINATED LAND MANAGEMENT ACT 1997 NOTICES UNDER SECTION 59(2)**

- (a) that the land to which the certificate relates is significantly contaminated land within the meaning of that Act - if the land (or part of the land) is significantly contaminated land at the date when the certificate is issued,

No.

- (b) that the land to which the certificate relates is subject to a management order within the meaning of that Act - if it is subject to such an order at the date when the certificate is issued,

No.

- (c) that the land to which the certificate relates is the subject of an approved voluntary management proposal within the meaning of that Act - if it is the subject of such an approved proposal at the date when the certificate is issued,

No.

- (d) that the land to which the certificate relates is subject to an ongoing maintenance order within the meaning of that Act - if it is subject to such an order at the date when the certificate is issued,

No.

- (e) that the land to which the certificate relates is the subject of a site audit statement within the meaning of that Act - if a copy of such a statement has been provided at any time to the local authority issuing the certificate.

No.

**Note: This Certificate is issued without Alteration and Erasure.**

---

## LAND USE TABLE

### Zone R1 General Residential

#### Draft Central Coast Local Environmental Plan

#### 1 Objectives of zone

To provide for the housing needs of the community.

To provide for a variety of housing types and densities.

To enable other land uses that provide facilities or services to meet the day to day needs of residents.

To promote best practice in the design of multi dwelling housing and other similar types of development.

To ensure that non-residential uses do not adversely affect residential amenity or place demands on services beyond the level reasonably required for multi dwelling housing or other similar types of development.

#### 2 Permitted without consent

Home occupations; Recreation areas.

#### 3 Permitted with consent

Attached dwellings; Bed and breakfast accommodation; Boat launching ramps; Boat sheds; Boarding houses; Car parks; Caravan parks; Centre-based child care facilities; Community facilities; Dual Occupancies; Dwelling houses; Educational establishments; Emergency services facilities; Environmental facilities; Environmental protection works; Exhibition homes; Exhibition villages; Flood mitigation works; Group homes; Home-based child care; Home businesses; Home industries; Home occupations (sex services); Hostels; Hotel or motel accommodation; Information and education facilities; Jetties; Multi dwelling housing; Neighbourhood shops; Places of public worship; Residential flat buildings; Respite day care centres; Roads; Secondary dwellings; Semi-detached dwellings; Seniors housing; Serviced apartments; Sewage reticulation systems; Shop top housing; Signage; Water recycling facilities; Water reticulation systems; Water storage facilities.

#### 4 Prohibited

Any development not specified in item 2 or 3



Property:

LOT: 4 SP: 30311 4 27 Brougham Street EAST GOSFORD

GOSFORD CITY COUNCIL

No. 850 440

### SEWERAGE CONNECTION PLAN

OWNER: Precise Constructions

HOUSE No. 27

**THIS PLAN IS DIAGNOSTIC ONLY  
DISTANCES SCALED FROM THIS PLAN MAY NOT BE ACCURATE**

LOT 31 SEC. OF 6/11/83

STREET Brougham St

DISTRICT East Gosford

All plumbing and drafting work must be carried out in accordance with the provisions of Ordinance No. 48, Local Government Act, 1919, and to the satisfaction of the Council.

**RAIN OR SURFACE WATER IS NOT TO BE CONNECTED TO THE SEWER**

#### SYMBOLS AND ABBREVIATIONS

□	Boundary Trap	RV	Reflex Valve	T	Tubs	H	Basin
⊗	Inspection Shaft	IO	Inspection opening	K	Kitchen Sink	S	Shower
⊖	Pit	oV	Vacuum pipe	W	Water Closet	F	Floor Waste
⊕	Gully	vV	Vent pipe	B	Bath Waste	M	Washing Machine
		oV	Soil Vent pipe	oWS	Waste Stack		

SCALE 1:800

Distances/Depths in metres; Pipe diameters in millimetres

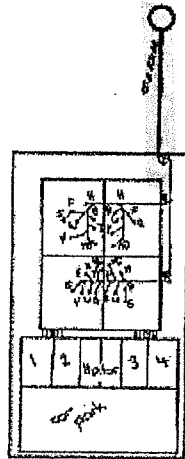

Brougham St

DRAINAGE - Supervised by <u>R. Bowen</u> <u>AO</u> PLUMBING - Supervised by _____ DRAWN BY - <u>L. Cross</u>	DATE <u>1-10-85</u>	PLUMBER <u>Clary</u> DRAINER _____
--	------------------------	---------------------------------------