



Copyright State of Victoria. No part of this publication may be reproduced except as permitted by the Copyright Act 1968 (Cth), to comply with a statutory requirement or pursuant to a written agreement. The information is only valid at the time and in the form obtained from the LANDATA REGD TM System. None of the State of Victoria, its agents or contractors, accepts responsibility for any subsequent publication or reproduction of the information.

The Victorian Government acknowledges the Traditional Owners of Victoria and pays respects to their ongoing connection to their Country, History and Culture. The Victorian Government extends this respect to their Elders, past, present and emerging.

**REGISTER SEARCH STATEMENT (Title Search) Transfer of
Land Act 1958**

Page 1 of 1

VOLUME 07900 FOLIO 111

Security no : 124121747764B
Produced 05/02/2025 10:09 AM

LAND DESCRIPTION

Lot 14 on Plan of Subdivision 026077.
PARENT TITLE Volume 07900 Folio 101
Created by instrument 2413895 02/07/1951

REGISTERED PROPRIETOR

Estate Fee Simple
Joint Proprietors

NEVILLE JOHN MANN of 42 JACKMAN CRESCENT KEILOR VIC 3036
DARYLE ALEXANDER MANN of 6 COOK PLACE LESMURDIE WA 6076 Executor(s) of ELIZA
MARY DOROTHY MANN deceased
AW531573A 08/02/2023

ENCUMBRANCES, CAVEATS AND NOTICES

Any encumbrances created by Section 98 Transfer of Land Act 1958 or Section 24 Subdivision Act 1988 and any other encumbrances shown or entered on the plan or imaged folio set out under DIAGRAM LOCATION below.

DIAGRAM LOCATION

SEE LP026077 FOR FURTHER DETAILS AND BOUNDARIES

ACTIVITY IN THE LAST 125 DAYS

NIL

-----END OF REGISTER SEARCH STATEMENT-----

Additional information: (not part of the Register Search Statement)

Street Address: 22 PAUL AVENUE BOX HILL NORTH VIC 3129

ADMINISTRATIVE NOTICES

NIL

eCT Control 21291Q BARNETT & BARNETT
Effective from 08/02/2023

DOCUMENT END



Imaged Document Cover Sheet

The document following this cover sheet is an imaged document supplied by LANDATA®, Secure Electronic Registries Victoria.

| | |
|---|-------------------------|
| Document Type | Plan |
| Document Identification | LP026077 |
| Number of Pages (excluding this cover sheet) | 2 |
| Document Assembled | 05/02/2025 10:09 |

Copyright and disclaimer notice:

© State of Victoria. This publication is copyright. No part may be reproduced by any process except in accordance with the provisions of the Copyright Act 1968 (Cth) and for the purposes of Section 32 of the Sale of Land Act 1962 or pursuant to a written agreement. The information is only valid at the time and in the form obtained from the LANDATA® System. None of the State of Victoria, LANDATA®, Secure Electronic Registries Victoria Pty Ltd (ABN 86 627 986 396) as trustee for the Secure Electronic Registries Victoria Trust (ABN 83 206 746 897) accept responsibility for any subsequent release, publication or reproduction of the information.

The document is invalid if this cover sheet is removed or altered.

**PLAN OF SUBDIVISION OF
PART OF CROWN ALLOTMENT 1
PARISH OF NUNAWADING
COUNTY OF BOURKE**

LP 26077

EDITION 3

PLAN MAY BE LODGED
22/05/53

VOL.5728 FOL.561
VOL.7900 FOL.101
Measurements are in Feet & Inches
Conversion Factor
FEET X 0.3048 = METRES

- ENCUMBRANCES**
AS TO THE LAND MARKED E-2:
THE CARRIAGE WAY EASEMENT
RESERVED BY TR. 2203354
- AS TO THE LAND MARKED E-2 & E-3:
THE EASEMENT OF WAY
CREATED BY INST. 2236065
- AS TO THE LAND MARKED E-2 & E-3:
THE EASEMENT OF WAY
CREATED BY INST.A388433
- AS TO THE LAND MARKED E-5 & E-6
THE RIGHT OF CARRIAGEWAY CREATED
BY INSTRUMENT 2585346
- AS TO THE LAND MARKED E-6
ANY EASEMENTS AFFECTING
THE SAME

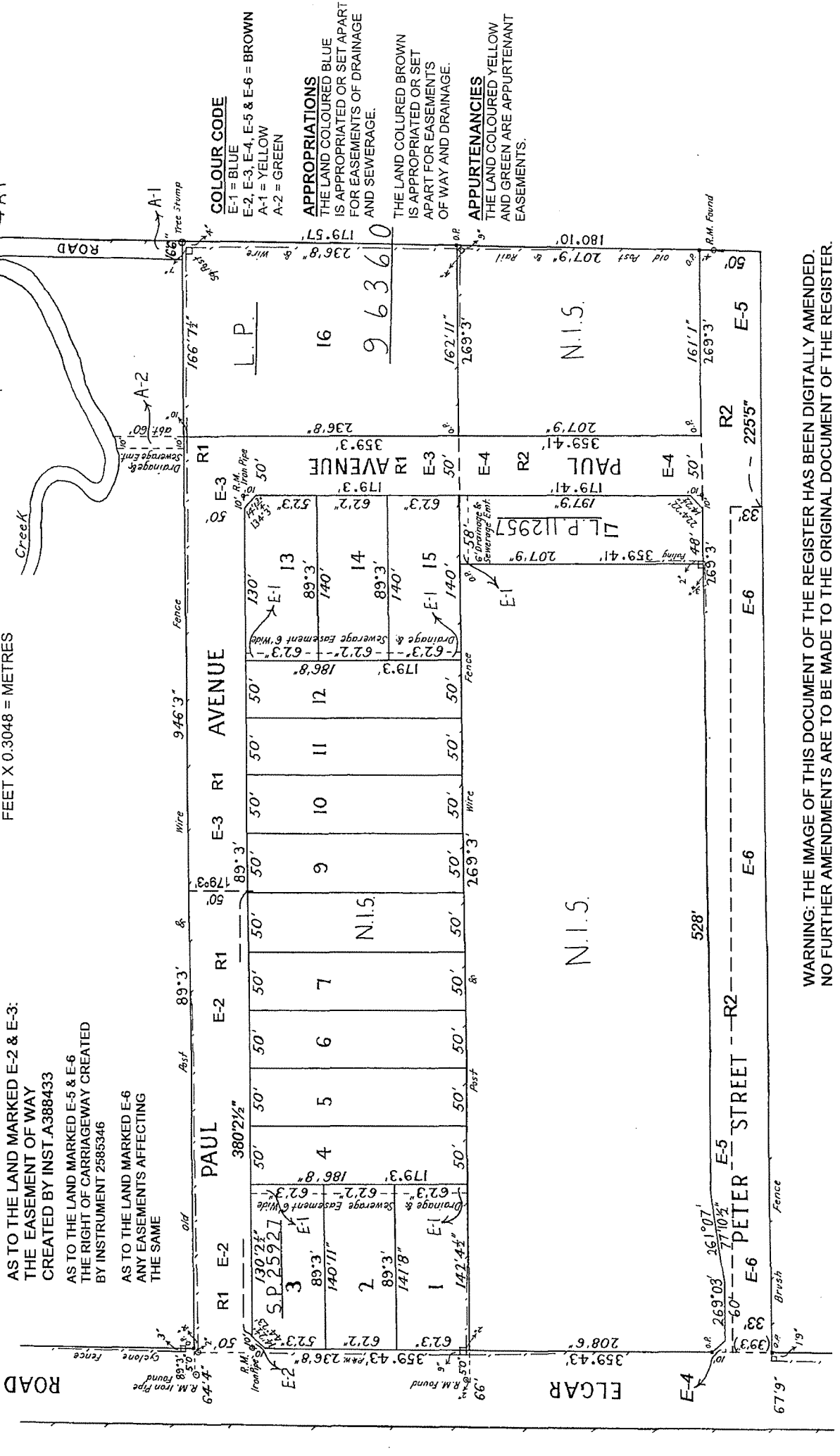

COLOUR CODE
E-1 = BLUE
E-2, E-3, E-4, E-5 & E-6 = BROWN
A-1 = YELLOW
A-2 = GREEN

APPROPRIATIONS
THE LAND COLOURED BLUE
IS APPROPRIATED OR SET APART
FOR EASEMENTS OF DRAINAGE
AND SEWERAGE.

THE LAND COLOURED BROWN
IS APPROPRIATED OR SET
APART FOR EASEMENTS
OF WAY AND DRAINAGE.

APPURTENANCES
THE LAND COLOURED YELLOW
AND GREEN ARE APPURTENANT
EASEMENTS.

WARNING: THE IMAGE OF THIS DOCUMENT OF THE REGISTER HAS BEEN DIGITALLY AMENDED.
NO FURTHER AMENDMENTS ARE TO BE MADE TO THE ORIGINAL DOCUMENT OF THE REGISTER.

